

| | |
|--|---------------------------------|
| Date of Action: 3.23.15 | |
| Approved <input checked="" type="checkbox"/> | Denied <input type="checkbox"/> |
| By: <i>K Smith</i> | |

CITY COUNCIL ACTION MEMORANDUM

AM No. 15-13: Contract Amendment to Hattenburg, Dilley and Linnell in the amount of \$99,315 for Engineering Services for Turn Lanes and Mack Drive Extension North as part of the South Mack Drive (Clapp Street) Extension Project.

Originator: Public Works Director

Date: March 11, 2015

Agenda of: March 23, 2015

| Route to: | Department Head | Signature | Date |
|-----------|-----------------------|--------------------|---------|
| X | Public Works Director | <i>[Signature]</i> | 3/11/15 |
| X | Finance Director | <i>[Signature]</i> | 3/11/15 |
| X | Deputy Administrator | <i>[Signature]</i> | 3/11/15 |
| X | City Clerk | <i>[Signature]</i> | 3.12.15 |

Reviewed by Mayor Bert L. Cottle: *[Signature]* 03.10.2015

Fiscal Impact: yes \$99,315

Funds Available: yes

Account name/number: S. Mack Drive-State/160-4320-432-45-65

Attachments: Project Map and HDL Fee Proposal (10 pages)

Summary Statement: This is a continuation of the engineering contract awarded to Hattenburg, Dilley and Linnell in 2009 through Request for Proposal No. 0704-0-2008/AG. The S. Mack Drive-Clapp Street Extension project has additional funding from the Borough to extend Mack Drive north from Knik-Goose Bay Road approximately 1,200 feet and tie-into the Mack-Clapp project. In addition, the Borough has funding to construct turn lanes at the Menard Center to make for safer access into and out of the facility. Engineering needs to be completed for this additional work. The City has grant funding available for the engineering and this action memorandum is proposed to authorize this phase of the project.

Staff Recommendation: Adopt AM No. 15-13.

PROJECT MAP

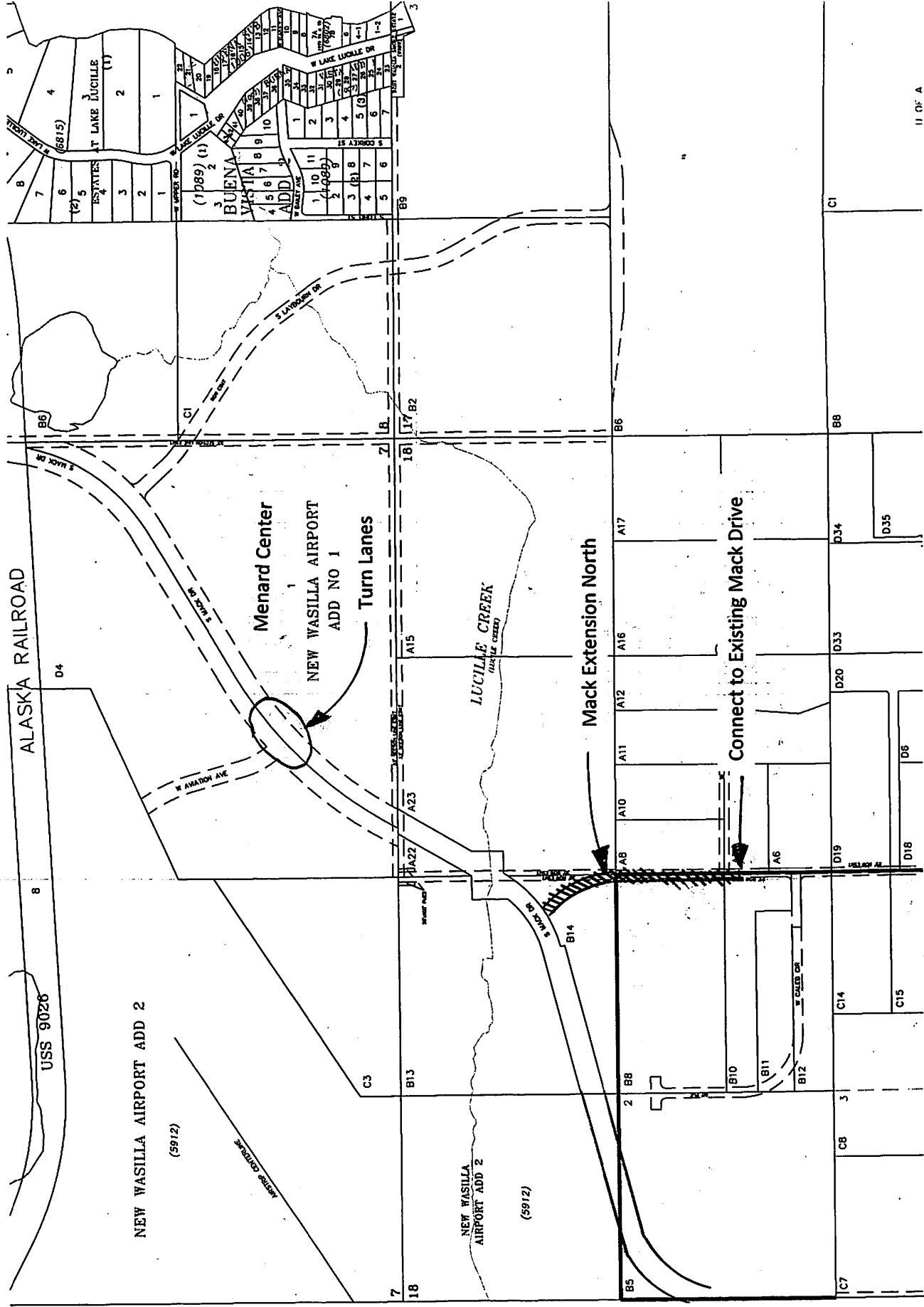

February 13, 2015

File No. 09-006

Archie Giddings, Public Works Director
City of Wasilla
290 East Herning Avenue
Wasilla, AK 99654-7091

Re: Proposal for Amendment 7 - Professional Services for Turn Lanes & Mack Drive
Extension North
City of Wasilla - S. Mack Drive (Clapp Street) Extension

CIVIL
ENGINEERING

Dear Mr. Giddings:

GEOTECHNICAL
ENGINEERING

Hattensburg Dilley & Linnell (HDL) is pleased to present this fee proposal for additional professional services on the South Mack Drive (Clapp Street) project. To date, HDL has provided the City of Wasilla (Wasilla) with final design of the Mack Drive Extension/Clapp Street Upgrade project. We are currently providing construction administration services for the Matanuska-Susitna Borough's (MSB) construction contract.

TRANSPORTATION
ENGINEERING

ENVIRONMENTAL
SERVICES

Recently, Wasilla and MSB discussed adding two additional elements to the project. This fee proposal is for professional services for the additional project scope:

PLANNING

- A center-left-turn lane into the northern entrance of the Menard Sports Center and a center left-turn lane at the intersection of the southern entrance to the Center and Aviation Avenue; and
- A northern extension of Mack Drive from the existing end near Mill Site Drive to the proposed Clapp Street.

SURVEYING

CONSTRUCTION
ADMINISTRATION

MATERIAL
TESTING

HDL proposes to provide Wasilla with surveying, environmental review and permitting, design, a geotechnical investigation, and ROW acquisition services.

SCOPE OF SERVICES

HDL will provide professional services using the scope of services in our current contract with the following additional details and clarifications:

Task 1: Environmental Review and Permitting

The proposed turn lanes on Clapp Street project would not impact any protected environmental resources and would not require any permits or approvals prior to construction. The project would be constructed within the disturbed footprint of the existing roadway. However, for the Mack Drive Extension North, HDL proposes to complete the following:

- *State Projects Environmental Checklist.* HDL will prepare a State Projects Environmental Checklist to identify any permits and clearances necessary for construction and document due diligence.
- *Wetlands Jurisdictional Determination and Permitting.* The Mack Drive Extension North includes crossing of wetlands. HDL will consult with US Army Corps of Engineers (USACE) to request a jurisdictional determination (JD). If required, HDL will prepare and submit a Pre-Construction Notification to USACE requesting verification of permit coverage under a Nationwide Permit.
- *Office of History and Archaeology Consultation.* HDL will consult with the Alaska Office of History and Archaeology under the Alaska Historic Preservation Act, requesting OHA concur with a finding that no significant cultural resources affected by the project, and that the project may proceed without conducting an additional cultural resources survey.

Task 2: Surveying Services

HDL will expand our design survey in front of the Sports Center to include the west side of the roadway. For the Mack Extension North, we will expand our control network and perform a design survey at the north end of the existing roadway. We will utilize MSB LiDAR data for topographic information along the new roadway alignment. Under this task, we will also prepare easement graphics and provide support for easement acquisition.

Task 3: Traffic & Safety Analysis

We do not anticipate any additional effort for this task.

Task 4: Preliminary Engineering Report

We do not anticipate any additional effort for this task.

Task 5: Public Involvement

We do not anticipate any additional effort for this task.

Task 6: Utilities

We will coordinate with the utility companies to identify any necessary relocations. If any are required, we will amend the existing utility relocation agreements as necessary. We anticipate this work can be accomplished without any additional budget.

Task 7: Geotechnical Investigation

HDL will perform a geotechnical evaluation along the proposed alignment that will consist of a reconnaissance and advancing one (1) geotechnical boring or test pit to a depth of 15 feet. Following the site evaluation, laboratory samples will be tested in our accredited soils laboratory and a geotechnical memo will be provided summarizing the results, conclusions, and geotechnical recommendations for the project.

Task 8: Plans, Specifications & Estimate

HDL will prepare plans to be added to the existing construction contract by change order. We will modify specification sections as necessary and prepare a bid schedule.

Task 9: Construction Assistance

Additional construction assistance budget may be necessary to accommodate changes in the performance period, work schedule, and testing quantities. If necessary, we will submit a budget amendment request once the changes are known.

Task 10: Right of Way Acquisition

We anticipate up to three easements will be required for the Mack Drive Extension North. HDL will prepare easement documents and graphics and contact the landowners with offers to purchase the easements on behalf of Wasilla. We will review and update the previously determined values for two of the properties and determine a value for the third property. Based on our previous experience, we anticipate two of the owners will be willing sellers; however we have no experience with the third owner. We have prepared our estimate assuming negotiations will be minimal.

FEE PROPOSAL

Our estimated fee for the additional services included in this amendment request is \$99,315.00 as shown on the attached fee proposal worksheet. This work will be performed on the same terms as our current contract.

We look forward to continuing our work with the City on this project. If you have any questions, you can contact me at 746-5230.

Sincerely,

HATTENBURG DILLEY & LINNELL, LLC



David Lundin, P.E.
Project Manager

Attach: Amendment 7 Fee Proposal Worksheet (6 pages)

| | | |
|--|--|------------------------|
| FIRM: Hattenburg Dilley & Linnell | PROJECT TITLE: South Mack Extension Amend. 7 Add'l Services - Turn Lanes & Mack Dr Extension North | DATE: 2/12/2015 |
|--|--|------------------------|

TOTAL NEGOTIATED FIXED FEE: **\$0**

| ARTICLE | TASK | LABOR (or FP) | INDIRECT COST | EXPENSES | TOTAL COST | FEE DISTRIBUTION | FIRM'S TOTAL PRICE | *SUB- CONTRACTS | PRICE PLUS SUBS |
|---------|------|------------------|------------------|----------|------------|---------------------|-----------------------|--------------------|--------------------|
| B7 | 1 | \$13,980 | \$0 | \$0 | \$13,980 | | \$13,980 | \$0 | \$13,980 |
| B16 | 2 | \$19,510 | \$0 | \$0 | \$19,510 | | \$19,510 | \$0 | \$19,510 |
| B9 | 3 | \$0 | \$0 | \$0 | \$0 | | \$0 | \$0 | \$0 |
| B10 | 4 | \$0 | \$0 | \$0 | \$0 | | \$0 | \$0 | \$0 |
| B11 | 5 | \$0 | \$0 | \$0 | \$0 | | \$0 | \$0 | \$0 |
| B12 | 6 | \$0 | \$0 | \$0 | \$0 | | \$0 | \$0 | \$0 |
| B13 | 7 | \$5,620 | \$0 | \$385 | \$6,005 | | \$6,005 | \$3,410 | \$9,415 |
| B14 | 8 | \$45,690 | \$0 | \$0 | \$45,690 | | \$45,690 | \$0 | \$45,690 |
| B15 | 9 | \$0 | \$0 | \$0 | \$0 | | \$0 | \$0 | \$0 |
| B16 | 10 | \$8,520 | \$0 | \$0 | \$8,520 | | \$8,520 | \$2,200 | \$10,720 |
| | | | | | | | | | |
| | | | | | | | | | |
| | | | | | | | | | |
| | | | | | | | | | |
| | | | | | | | | | |
| | | | | | | | | | |
| | | | | | | | | | |
| | | | | | | | | | |
| | | | | | | | | | |
| | | | | | | | | | |
| | | | | | | | | | |
| | | | | | | | | | |
| | | | | | | | | | |
| | | | | | | | | | |
| | | | | | | | | | |
| | | | | | | | | | |
| | | | | | | | | | |
| | | | | | | | | | |
| | | | | | | | | | |
| | | | | | | | | | |
| | | | | | | | | | |
| | | | | | | | | | |

*Subcontractors for negotiated professional or technical services, products, etc. (Commodity items available to the general public at market prices, equipment use, and unit priced items are generally included in estimate as expenses.)

| ESTIMATED TOTALS | LABOR (or FP) | INDIRECT COST | EXPENSES | TOTAL COST | FEE | FIRM'S TOTAL PRICE | *SUB- CONTRACTS | PRICE PLUS SUBS |
|---------------------|------------------|------------------|----------|------------|-----|-----------------------|--------------------|--------------------|
| FOR FIRM: | \$93,320 | \$0 | \$385 | \$93,705 | \$0 | \$93,705 | \$5,610 | \$99,315 |

COST ESTIMATE PER TASK

| FIRM: Hattenburg Dilley & Linnell | | | PROJECT TITLE: Amend. 7 Add'l Services - Turn Lanes & Mack Dr Extension North | | | | | | | | | | |
|--|-----------------------------------|------------------------------------|---|--------------------------|--|------------------------------------|--|-------------------------------------|---------|--------------------------|--------------|--------------|--------|
| TASK NO: | 1 | TASK DESCRIPTION: | Environmental Services | | | | | | | | DATE: | 2/12/2015 | |
| GROUP: | | METHOD OF PAYMENT: | FP | <input type="checkbox"/> | FPPE | <input type="checkbox"/> | T&E | <input checked="" type="checkbox"/> | CPFF | <input type="checkbox"/> | PREPARED BY: | David Lundin | |
| SUB-TASK NO. | SUB-TASK DESCRIPTION | LABOR HOURS PER JOB CLASSIFICATION | | | | | | | | | | | |
| | | Prncipal/ Proj Mgr | Civil Eng | Environ. Manager | Environ. Specialist | GIS Specialist | Drafter | Clerical | | | | | |
| B7.1 | General Mgmt & Coordination | 2 | 4 | 4 | 4 | | | 1 | | | | | |
| B16 | | | | | | | | | | | | | |
| B7.2 | Environmental Analysis Site Visit | | | | | | | | | | | | |
| B7.2.1 | - Wetland Delineation | | | 2 | 10 | 4 | | | | | | | |
| B7.2.2 | - Fish Habitat | | | | | | | | | | | | |
| B7.2.3 | - Vegetation/Habitat | | | | | | | | | | | | |
| B7.2.4 | - Hazardous Waste | | | | | | | | | | | | |
| B7.2.5 | - Cultural Resources | | | 4 | 8 | | 4 | | | | | | |
| B7.2.6 | - Threatened and Endangered | | | | | | | | | | | | |
| B7.3 | Environmental Checklist | | | 6 | 40 | | 10 | 2 | | | | | |
| B7.4 | Permitting | | 4 | 4 | 24 | | 8 | | | | | | |
| B7.5 | Public and Agency Coordination | | | | | | | | | | | | |
| B7.6 | Revised Environmental Checklist | | | | | | | | | | | | |
| TOTAL LABOR HOURS | | 2 | 8 | 20 | 86 | 4 | 22 | 3 | 0 | 0 | 0 | 0 | 0 |
| * LABOR RATES (\$/HR) | | \$165.00 | \$115.00 | \$150.00 | \$85.00 | \$85.00 | \$85.00 | \$70.00 | \$85.00 | \$70.00 | \$0.00 | \$0.00 | \$0.00 |
| LABOR COSTS (\$) | | \$330.00 | \$920.00 | \$3,000.00 | \$7,310.00 | \$340.00 | \$1,870.00 | \$210.00 | \$0.00 | \$0.00 | \$0.00 | \$0.00 | \$0.00 |
| EXPENSES | | | | | | | | | | | | | |
| SUB-TASK NO. | ITEM(S) | QUANTITY | UNIT PRICE | TOTAL PRICE | COMMENTS: Assumes no public or agency scoping, no development of mitigation/MOU for impacts to historic properties, no floodplain development permit, one COW review of all project documentation. Assumes no field-based wetland delineation is required and no cultural resource survey is required. Assumes project will qualify for Section 404 NWP and no individual wetland permit is required. | | | | | | | | |
| | | | | \$0.00 | | | | | | | | | |
| | | | | \$0.00 | | | | | | | | | |
| | | | | \$0.00 | | | | | | | | | |
| | | | | \$0.00 | | | | | | | | | |
| | | | | \$0.00 | | | | | | | | | |
| | Markup at 10% | | | \$0.00 | FIRM'S TOTAL COST OF LABOR (or Fixed Price): | \$13,980 | | | | | | | |
| | | | | \$0.00 | IF CPFF, TOTAL INDIRECT COST @ | 0.00% | \$0 | | | | | | |
| | | | | TOTAL EXPENSES: | \$0 | FIRM'S TOTAL EXPENSES | \$0 | | | | | | |
| SUB-CONTRACTORS: Firm Initials and Price Per Task | | | | | | | FIRM'S TOTAL COST (no Subcontracts or Fee) | \$13,980 | | | | | |
| FIRM: | | | | Subtotal | 10% Markup | | | | | | | | |
| AMOUNT: | | | | \$0 | \$0 | TOTAL SUBCONTRACTOR PRICES: | \$0 | | | | | | |

* Labor Rates shall be direct labor (base pay) only if Method of Payment is CPFF; otherwise, Labor Rates shall be total rates (i.e. base pay + benefits + overhead + profit.)

COST ESTIMATE PER TASK

| FIRM: Hattenburg Dilley & Linnell | | | | PROJECT TITLE: Amend. 7 Add'l Services - Turn Lanes & Mack Dr Extension North | | | | | | | | |
|--|---|--|----------------|---|---|------------------------------|------------------------------------|---------------|-----------------|--------|---|----------|
| TASK NO: 2 | | TASK DESCRIPTION: Surveying Services | | | | | | | DATE: 2/12/2015 | | | |
| GROUP: | | METHOD OF PAYMENT: FP <input type="checkbox"/> FPPE <input type="checkbox"/> T&E <input checked="" type="checkbox"/> CPFF <input type="checkbox"/> | | | | PREPARED BY: David Lundin | | | | | | |
| SUB-TASK NO. | SUB-TASK DESCRIPTION | LABOR HOURS PER JOB CLASSIFICATION | | | | | | | | | | |
| | | Principal/ Proj Mgr | Survey Manager | Survey Tech.XIV | Survey Tech. IX | 3-Man Crew | 2-Man Crew | 2-Man Crew OT | Clerical | | | |
| | General Mgmt & Coordination | 4 | | | | | | | | | | |
| B8.9 | Surveying for Preliminary Design Research | | 2 | 4 | | | | | | | | |
| B16 | Horizontal Control | | | | | | 4 | | | | | |
| 8.9.1 | Vertical Control | | | | | | 4 | | | | | |
| | Monument Ties | | | | | | 8 | | | | | |
| B8.10 | Topographic Design Survey | | 4 | 4 | | | 24 | | | | | |
| B8.10 | Topographic Drawing | | 4 | 16 | | | | | | | | |
| B8.13.3 | Right of Way Easement Exhibits/Legal | | 4 | 8 | | | | | | | | |
| B8.13.4 | ROW Acquisition Support | | 4 | 8 | | | 8 | | | | | |
| | Deliverables | 2 | 4 | 16 | | | | | | | | |
| TOTAL LABOR HOURS | | 6 | 22 | 56 | 0 | 0 | 48 | 0 | 0 | 0 | 0 | |
| * LABOR RATES (\$/HR) | | \$165.00 | \$140.00 | \$100.00 | \$75.00 | \$230.00 | \$205.00 | \$215.00 | \$70.00 | \$0.00 | \$0.00 | |
| LABOR COSTS (\$) | | \$990.00 | \$3,080.00 | \$5,600.00 | \$0.00 | \$0.00 | \$9,840.00 | \$0.00 | \$0.00 | \$0.00 | \$0.00 | |
| EXPENSES | | | | | | | | | | | | |
| SUB-TASK NO. | ITEM(S) | QUANTITY | UNIT PRICE | TOTAL PRICE | COMMENTS: Assumes survey will be performed in winter 2015. Cost does not include platting. Design survey for turn lanes; design survey existing north end of Mack only (use LIDAR for base map for new road alignment). | | | | | | | |
| | | | | \$0.00 | | | | | | | | |
| | | | | \$0.00 | | | | | | | | |
| | | | | \$0.00 | | | | | | | | |
| | | | | \$0.00 | | | | | | | | |
| | | | | \$0.00 | | | | | | | | |
| | Markup at 10% | | | \$0.00 | FIRM'S TOTAL COST OF LABOR (or Fixed Price): | | | | \$19,510 | | | |
| | | | | \$0.00 | IF CPFF, TOTAL INDIRECT COST @ | | 0.00% | | \$0 | | | |
| | | | | TOTAL EXPENSES: | \$0 | FIRM'S TOTAL EXPENSES | | | | | \$0 | |
| SUB-CONTRACTORS: Firm Initials and Price Per Task | | | | | | | | | | | FIRM'S TOTAL COST (no Subcontracts or Fee) | \$19,510 |
| FIRM: | | | | | Subtotal | 10% Markup | | | | | | |
| AMOUNT: | | | | | \$0 | \$0 | TOTAL SUBCONTRACTOR PRICES: | | | | | \$0 |

* Labor Rates shall be direct labor (base pay) only if Method of Payment is CPFF; otherwise, Labor Rates shall be total rates (i.e. base pay + benefits + overhead + profit.)

COST ESTIMATE PER TASK

| FIRM: Hattenburg Dilley & Linnell | | | | PROJECT TITLE: Amend. 7 Add'l Services - Turn Lanes & Mack Dr Extension North | | | | | | | |
|--|--|------------------------------------|---------------------|---|-------------------|--------------|--|----------|--------|-----------------|--------|
| TASK NO: 7 | TASK DESCRIPTION: Geotechnical Investigation | | | | | | | | | DATE: 2/12/2015 | |
| GROUP: | METHOD OF PAYMENT: FP <input type="checkbox"/> FPPE <input type="checkbox"/> T&E <input checked="" type="checkbox"/> CPFF <input type="checkbox"/> | | | | | | PREPARED BY: David Lundin | | | | |
| SUB-TASK NO. | SUB-TASK DESCRIPTION | LABOR HOURS PER JOB CLASSIFICATION | | | | | | | | | |
| | | Principal Geotech | Principal/ Proj Mgr | Geotech Engineer | Project Geologist | Lab Tech. | Drafter | Clerical | | | |
| B13.2 | Coordination and management | | 2 | | | | | | | | |
| B13.2 | Site visits | | | 4 | | | | | | | |
| B16 | Geotech fieldwork | | | | 8 | | | | | | |
| B13.2 | Laboratory testing | | | | | 4 | | | | | |
| B13.3 | Engineering Analysis and Draft Report | | | 4 | 16 | | 2 | | | | |
| B13.3 | Final Report | | | 2 | 8 | | 1 | | | | |
| TOTAL LABOR HOURS | | 0 | 2 | 10 | 32 | 4 | 3 | 0 | 0 | 0 | 0 |
| * LABOR RATES (\$/HR) | | \$170.00 | \$165.00 | \$145.00 | \$100.00 | \$85.00 | \$100.00 | \$70.00 | | | |
| LABOR COSTS (\$) | | \$0.00 | \$330.00 | \$1,450.00 | \$3,200.00 | \$340.00 | \$300.00 | \$0.00 | \$0.00 | \$0.00 | \$0.00 |
| SUB-TASK NO. | | ITEM(S) | | QUANTITY | UNIT PRICE | TOTAL PRICE | COMMENTS: Assumes one additional boring on Mack at north end of the existing road. | | | | |
| 13.1 | Field Supplies | | 1 | \$200.00 | \$200.00 | | | | | | |
| 13.1 | Truck Rental | | 2 | \$75.00 | \$150.00 | | | | | | |
| | | | | | \$0.00 | | | | | | |
| | | | | | \$0.00 | | | | | | |
| Markup at 10% | | | | | | \$35.00 | FIRM'S TOTAL COST OF LABOR (or Fixed Price): \$5,620 | | | | |
| | | | | | | | IF CPFF, TOTAL INDIRECT COST @ 0.00% \$0 | | | | |
| TOTAL EXPENSES: | | | | | | \$385 | FIRM'S TOTAL EXPENSES \$385 | | | | |
| SUB-CONTRACTORS: Firm Initials and Price Per Task | | | | | | | FIRM'S TOTAL COST (no Subcontracts or Fee) \$6,005 | | | | |
| FIRM: | Geotek Alaska | | | | Subtotal | 10% Markup | | | | | |
| AMOUNT: | \$3,100 | | | | \$3,100 | \$310 | TOTAL SUBCONTRACTOR PRICES: \$3,410 | | | | |

* Labor Rates shall be direct labor (base pay) only if Method of Payment is CPFF; otherwise, Labor Rates shall be total rates (i.e. base pay + benefits + overhead + profit.)

COST ESTIMATE PER TASK

| FIRM: Mattenbun Dille & Linnell | | | PROJECT TITLE: Amend. 7 Add'l Services - Turn Lanes & Mack Dr Extension North | | | | | | | | | | |
|--|---|------------------------------------|--|-------------|---|------------------------------------|-----------|--------|------------------------|--------|--------|--------|----|
| TASK NO: 8 | TASK DESCRIPTION: Plans, Specifications, and Estimate | | | | | | | | DATE: 2/12/2015 | | | | |
| GROUP: | METHOD OF PAYMENT: FP <input type="checkbox"/> FPPE <input type="checkbox"/> T&E <input checked="" type="checkbox"/> CPFF <input type="checkbox"/> | | | | | PREPARED BY: David Lundin | | | | | | | |
| SUB-TASK NO. | SUB-TASK DESCRIPTION | LABOR HOURS PER JOB CLASSIFICATION | | | | | | | | | | | |
| | | Principal/ Proj Mgr | Civil Engineer | Engr Asst | Drafter | Clerical | | | | | | Sheets | |
| B14.1 | General Mgmt & Coordination | 16 | | | | 6 | | | | | | | |
| B14.1 | QA & Oversight | 8 | | | | | | | | | | | |
| B14.1 | Sight Meeting | | 4 | | | | | | | | | | |
| B16 | Title/Legend/Layout | | | | | | | | | | | | |
| B14.1 | Survey Control | | | | | | | | | | | | |
| B14.1 | Typical Sections | | 4 | 8 | 8 | | | | | | | | 1 |
| B14.1 | Estimate of Quantities | | 2 | 2 | 4 | | | | | | | | 1 |
| B14.1 | Summary Sheets | | 2 | 4 | 8 | | | | | | | | 3 |
| B14.1 | Detail Sheets | | 2 | 2 | 8 | | | | | | | | 1 |
| B14.1 | Erosion and Sediment Control | | | | | | | | | | | | |
| B14.1 | Plan and Profile - Roadway | | 16 | 32 | 32 | | | | | | | | 4 |
| B14.1 | Approach Profiles | | 2 | 8 | 8 | | | | | | | | 1 |
| B14.1 | Signing & Striping | | | 12 | 8 | | | | | | | | 1 |
| B14.1 | Illumination & Signalization | | none required | | | | | | | | | | |
| B14.1 | Traffic Control Plan | | | 4 | 4 | | | | | | | | 1 |
| B14.1 | ROW Maps | | none required | | | | | | | | | | |
| B14.1 | Specifications | | 8 | | | | | | | | | | |
| B14.1 | Estimate & Quantities | | 4 | 24 | 8 | | | | | | | | |
| B14.1 | Cross Sections | | 4 | 24 | 12 | | | | | | | | 12 |
| B14.2 | 85% Review | 2 | 8 | 32 | 32 | | | | | | | | |
| B14.3 | 95% Review | 2 | 8 | 16 | 16 | | | | | | | | |
| B14.4 | Final PS&E | 2 | 8 | 16 | 16 | | | | | | | | |
| TOTAL LABOR HOURS | | 30 | 72 | 184 | 164 | 6 | 0 | 0 | 0 | 0 | 0 | 0 | 25 |
| * LABOR RATES (\$/HR) | | \$165.00 | \$115.00 | \$85.00 | \$100.00 | \$70.00 | \$0.00 | \$0.00 | \$0.00 | \$0.00 | \$0.00 | \$0.00 | |
| LABOR COSTS (\$) | | \$4,950 | \$8,280 | \$15,640 | \$16,400 | \$420 | \$0 | \$0 | \$0 | \$0 | \$0 | \$0 | |
| EXPENSES | | | | | | | | | | | | | |
| SUB-TASK NO. | ITEM(S) | QUANTITY | UNIT PRICE | TOTAL PRICE | COMMENTS: Assumes 1) ROW illumination and signalization are not included. 2) Plans will be added to Mack Drive Extension as a change order. 3) bidding and construction services are not included. | | | | | | | | |
| | | | | \$0.00 | | | | | | | | | |
| | | | | \$0.00 | | | | | | | | | |
| | | | | \$0.00 | | | | | | | | | |
| | | | | \$0.00 | | | | | | | | | |
| | | | | \$0.00 | | | | | | | | | |
| | Markup at 10% | | | \$0.00 | FIRM'S TOTAL COST OF LABOR (or Fixed Price): | | \$45,690 | | | | | | |
| | | | | \$0.00 | IF CPFF, TOTAL INDIRECT COST @ | | 0.00% \$0 | | | | | | |
| TOTAL EXPENSES: | | | | \$0 | FIRM'S TOTAL EXPENSES | | \$0 | | | | | | |
| SUB-CONTRACTORS: Firm Initials and Price Per Task | | | | | FIRM'S TOTAL COST (no Subcontracts or Fee) | | \$45,690 | | | | | | |
| FIRM: | | | | Subtotal | 10% Markup | | | | | | | | |
| AMOUNT: | | | | \$0 | \$0 | TOTAL SUBCONTRACTOR PRICES: | | \$0 | | | | | |

* Labor Rates shall be direct labor (base pay) only if Method of Payment is CPFF; otherwise, Labor Rates shall be total rates (i.e. base pay + benefits + overhead + profit.)

COST ESTIMATE PER TASK

| FIRM: Hattensburg Dilley & Linnell | | | | PROJECT TITLE: Amend. 7 Add'l Services - Turn Lanes & Mack Dr Extension North | | | | | | | | | | | |
|--|---|------------------------------------|-------------------|--|----------------------------------|----------|----------------|------------------------|--|----------|--|-----|-----|-----|-----|
| TASK NO: 10 | TASK DESCRIPTION: Right of Way Acquisition | | | | | | | DATE: 2/12/2015 | | | | | | | |
| GROUP: | METHOD OF PAYMENT: FP <input type="checkbox"/> FPPE <input type="checkbox"/> T&E <input checked="" type="checkbox"/> CPFF <input type="checkbox"/> | | | | PREPARED BY: David Lundin | | | | | | | | | | |
| SUB-TASK NO. | SUB-TASK DESCRIPTION | LABOR HOURS PER JOB CLASSIFICATION | | | | | | | | | | | | | |
| | | Principal/ Proj Mgr | Civil Engineer | Engr Asst | Drafter | Clerical | ROW Manager | ROW Asst | | | | | | | |
| | General Mgmt & Coordination | 8 | | | | | | | | | | | | | |
| B16 | Design | | | | | | | | | | | | | | |
| | Cost Estimates | | | | | | | | | | | | | | |
| B16.8.5 | Negotiations | | | | | | | | | 32 | 16 | | | | |
| B16.5.5 | Value Estimates | | | | | | | | | 4 | | | | | |
| TOTAL LABOR HOURS | | 8 | 0 | 0 | 0 | 0 | | | | 36 | 16 | 0 | 0 | 0 | 0 |
| * LABOR RATES (\$/HR) | | \$165.00 | \$130.00 | \$85.00 | \$100.00 | \$70.00 | | | | \$160.00 | \$90.00 | | | | |
| LABOR COSTS (\$) | | \$1,320 | \$0 | \$0 | \$0 | \$0 | | | | \$5,760 | \$1,440 | \$0 | \$0 | \$0 | \$0 |
| EXPENSES | | | | | | | | | | | COMMENTS: Assumes 3 easements for parcels from willing sellers. Assumes valuation for one parcel only. No extended negotiation or condemnation. | | | | |
| SUB-TASK NO. | | QUANTITY | UNIT PRICE | TOTAL PRICE | | | | | | | | | | | |
| | Reproductions, misc. | | | \$0.00 | | | | | | | | | | | |
| | | | | \$0.00 | | | | | | | | | | | |
| | | | | \$0.00 | | | | | | | | | | | |
| | | | | \$0.00 | | | | | | | | | | | |
| | | | | \$0.00 | | | | | | | | | | | |
| | | | | \$0.00 | | | | | | | | | | | |
| | | | | \$0.00 | | | | | | | | | | | |
| Markup at 10% | | | | \$0.00 | | | | | | | | | | | |
| TOTAL EXPENSES: | | | | | \$0 | | | | | | | | | | |
| | | | | | \$0 | | | | | | | | | | |
| SUB-CONTRACTORS: Firm Initials and Price Per Task | | | | | \$0 | | | | | | | | | | |
| | | | | | \$0 | | | | | | | | | | |
| | | | | | \$0 | | | | | | | | | | |
| FIRM'S TOTAL COST OF LABOR (or Fixed Price): | | | | | \$8,520 | | | | | | | | | | |
| IF CPFF, TOTAL INDIRECT COST @ | | | | | 0.00% | \$0 | | | | | | | | | |
| FIRM'S TOTAL EXPENSES | | | | | \$0 | | | | | | | | | | |
| FIRM'S TOTAL COST (no Subcontracts or Fee) | | | | | \$8,520 | | | | | | | | | | |
| FIRM: | | | | Subtotal | 10% Markup | | | | | | | | | | |
| AMOUNT: \$2,000 | | | | \$2,000 | \$200 | | | | | | | | | | |
| TOTAL SUBCONTRACTOR PRICES: | | | | | \$2,200 | | | | | | | | | | |

* Labor Rates shall be direct labor (base pay) only if Method of Payment is CPFF; otherwise, Labor Rates shall be total rates (i.e. base pay + benefits + overhead + profit.)