

Council Action:	
Approved: <input checked="" type="checkbox"/>	Denied: <input type="checkbox"/>
Date of Action: 7/22/19	
Verified by: <i>[Signature]</i>	

CITY COUNCIL ACTION MEMORANDUM

AM No. 19-30: Contract Award to Northwest Playground Equipment, Inc. in the amount of \$73,669 for Trail Head playground equipment.

Originator: Public Works Director
 Date: July 10, 2019

Agenda of: July 22, 2019

Route to:	Department Head	Signature	Date
X	Public Works Director	<i>[Signature]</i>	7/10/19
X	Finance Director	<i>[Signature]</i>	7.10.19
X	Deputy Administrator	unavailable	
X	City Clerk	<i>[Signature]</i>	7/10/19

Reviewed by Mayor Bert L. Cottle: *[Signature]* 7/11/2019

Fiscal Impact: yes or no **Funds Available:** yes
Account name/number: Trail Head Playground/110-4520-452.45-(new)
Attachments: Northwest Playground Equipment Proposal (5 pages)
 CIP Detail Sheet (1 page)

Summary Statement: This project was adopted in the FY2020 Capital Improvement program to install a new playground at the Lake Lucile Trail Head next to the Menard Center. This contract award is proposed in accordance with Wasilla Municipal Code 5.08.100.B.8 where the contract is awarded through a State of Alaska NASPO contract.

Staff Recommendation: Adopt AM No. 19-30.



Northwest Playground Equipment, Inc.

PO Box 2410, Issaquah, WA 98027-0109
Phone (425) 313-9161 FAX (425) 313-9194
Email: sales@nwplayground.com

QUOTE

This quote is only valid for 10 days.

To: City of Wasilla
Re: Canyons Cross' Structure

Quote # 722019ARL3U
Date: 7/9/2019

Contact Name: Jesse Griffiths
Email: jrgriffiths@ci.wasilla.ak.us

Phone: 907.232.6110
Cell/Fax:

Item #	Qty	Description	Price	Total Price
--------	-----	-------------	-------	-------------

EQUIPMENT

Playworld Systems

350-1705	1	Playworld Systems 'Canyon's Cross' SALE Structure Including; Glide Slide (48in Deck), ZigZag Slide (60in Deck), Sliding Pole (36in Deck), Accessible Driving Panel, Store Front Panel, Nuvo Activity Panel, Nuvo Construction Panel Insert, Nuvo Ball Maze Panel Insert, Access Gate, 24in Deck to Deck Climber, Rushmore, Rope Climber (36in Deck), Silo Climber (72in Deck), Spiral Climber (48in Deck), RockBlocks Deck Access Support (60in to 72in Deck), RockBlocks Z Supports (Raised 60in Wall and Standard 60in Wall), RockBlocks End Support (60in Wall), RockBlocks Tri Ladder (84in Wall), RockBlocks 90 Degree Wall (60in and 84in to 60in), RockBlocks End Wall (60in), The Helix (60in and 84in Wall), The Crater Arch, Leg Lift, 6ft Horizontal Spiral Ladder, Overhead Event Access Ladder (36in Deck), Drop Zone (72in Deck), 12in Deck to Deck Access Stepped Platform, and Nuvo 36in Transfer Station.		\$ 70,295.00
----------	---	--	--	--------------

Please Note that the Customer is Responsible for Offloading Equipment and Verifying Quantities and Descriptions. Please Note that the Above Pricing is in Agreement with the State of Alaska NASPO Master Agreement #6480.

Equipment Subtotal	\$ 70,295.00
State of Alaska NASPO Discount:	\$ (17,574.00)
Freight from Lewisburg, PA to Tacoma, WA Barge:	\$ 5,605.00
Freight from Tacoma, WA Barge to Wasilla, AK:	\$ 15,343.19
Equipment Total (less tax)	\$ 73,669.19

CERTIFIED INSTALLATION

Installation Notes: *Customer is Responsible for Installation, All Site Work, Safety Surfacing and Geotextile Fabric.*

Prevailing Wage Job		Installation Total:	\$ -
Bond or Credit Card Fee:	Performance Bond (If Required):	3.0%	\$ -
Location Code:	Resale Certificate Required for Tax Exemption:	Tax: 0.0%	\$ -
ORDER TOTAL:			\$ 73,669.19

All quotes are subject to material and fuel surcharges.

Acceptance of Proposal:

(Please be sure you have read, signed, initialed and understand the Terms and Conditions on Page 2 of this Quote)

The items, prices and conditions listed herein are satisfactory and are hereby accepted.

Asiley Larsen

Sales Assistant

Customer Signature

Date

Thank you for considering Northwest Playground Equipment, Inc. for your Park, Playground, Shelter and Sports Equipment requirements.



Northwest Playground Equipment, Inc.

PO Box 2410, Issaquah, WA 98027-0109

Phone (425) 313-9161 FAX (425) 313-9194

Email: sales@nwplayground.com

Project Name: Canyons Cross' Structure

Quote # 722019ARL3U

TERMS AND CONDITIONS

QUOTE CONDITIONS AND ACCEPTANCE:

This quote is only valid for 10 days.

Orders placed or requested for delivery after 10 days are subject to Steel and Material price increases and Surcharges .

*** _____ (Pls Initial) It is the Buyer's responsibility to verify quantities and description of items quoted.

Once your order has been placed, any changes including additions, deletions or color changes, will delay your shipment.

EXCLUSIONS: Unless specified, this quote specifically **excludes** all of the following:

- Required Permits; Davis Bacon, Certified Payroll or Prevailing Wage fees
- Performance/Payment Bonds
- Site work and landscaping
- Removal of existing equipment
- Unloading; Receiving of inventory or equipment; Storage of equipment
- Equipment assembly and/or installation
- Safety surfacing; Borders or drainage requirements
- Landscaping Repairs DUE to poor access or in climatic weather

FREIGHT AND DELIVERY:

Shipping is FOB Origin. A 24-hr Call Ahead is available at additional cost.

Delivery is currently 5+ weeks after order submittal. Unless otherwise noted, all equipment is delivered unassembled.

*** _____ (Pls Initial) **Buyer is responsible to meet and provide a minimum of 2 ADULTS to unload truck**

A Check List, detailing all items shipped, will be mailed to you and a copy will be included with the shipment.

Buyer is responsible for ensuring the Sales Order and Item Numbers on all boxes and pieces match the Check List.

*** _____ (Pls Initial) Shortages or damages must be noted on the driver's delivery receipt. Shortages or damages not noted become the buyers financial responsibility.

Damaged Freight must be refused. Please notify Northwest Playground Equipment immediately of any damages.

Shortages and Concealed Damage must be reported to Northwest Playground Equipment within 10 days of delivery.

A reconsignment fee will be charged for any changes made to delivery address after order has been placed.

TAXES:

All orders delivering in Washington are subject to applicable sales tax unless a tax exemption or Reseller Permit is on file at the time the order is placed.

PAYMENT TERMS: An approved Credit Application is required for new customers. 50% down payment is due at time of order

with balance due upon delivery, unless other credit terms have been approved. Interest may be charged on past due balances at an annual rate of 18%. A 3% charge will be added to all credit card orders.

RESTOCKING: Items canceled, returned or refused will be subject to a minimum 25% restocking fee. All return freight

charges are the responsibility of the Buyer.

MAINTENANCE/WARRANTY:

Manufacturer's standard product warranties apply and cover equipment replacement and freight costs only; labor is not included.

Northwest Playground Equipment offers no additional warranties.

Maintenance of the equipment and safety surfacing is the responsibility of the customer.

Any unauthorized alterations or modifications to the equipment (including layout) will void your warranty.

INSTALLATION: (if applicable)

A private locate service for underground utilities must be completed before your scheduled installation.

Site must be level and free of loose debris (this includes ground cover/chips).

A minimum 6 foot opening with good access must be available to the site for delivery trucks and tractor.

An onsite dumpster must be provided for disposal of packaging materials.

Arrangements must be made in advance for the disposal of dirt/rocks from within the installation area.

Arrangements must be made in advance for the removal/disposal of existing equipment.

Additional charges may apply if large rocks or concrete are found beneath the surface.

Access to power and water must be available.

Site supervision is quoted in 8-hour days.

Acceptance of Terms & Conditions

Acceptance of this proposal, made by an authorized agent of your company, indicates agreement to the above terms and conditions.

Ashley Larsen

Sales Assistant

Customer Signature

Date

Thank you for choosing Northwest Playground Equipment

Canyon's Cross

Equipment Manufacturer



350-1705

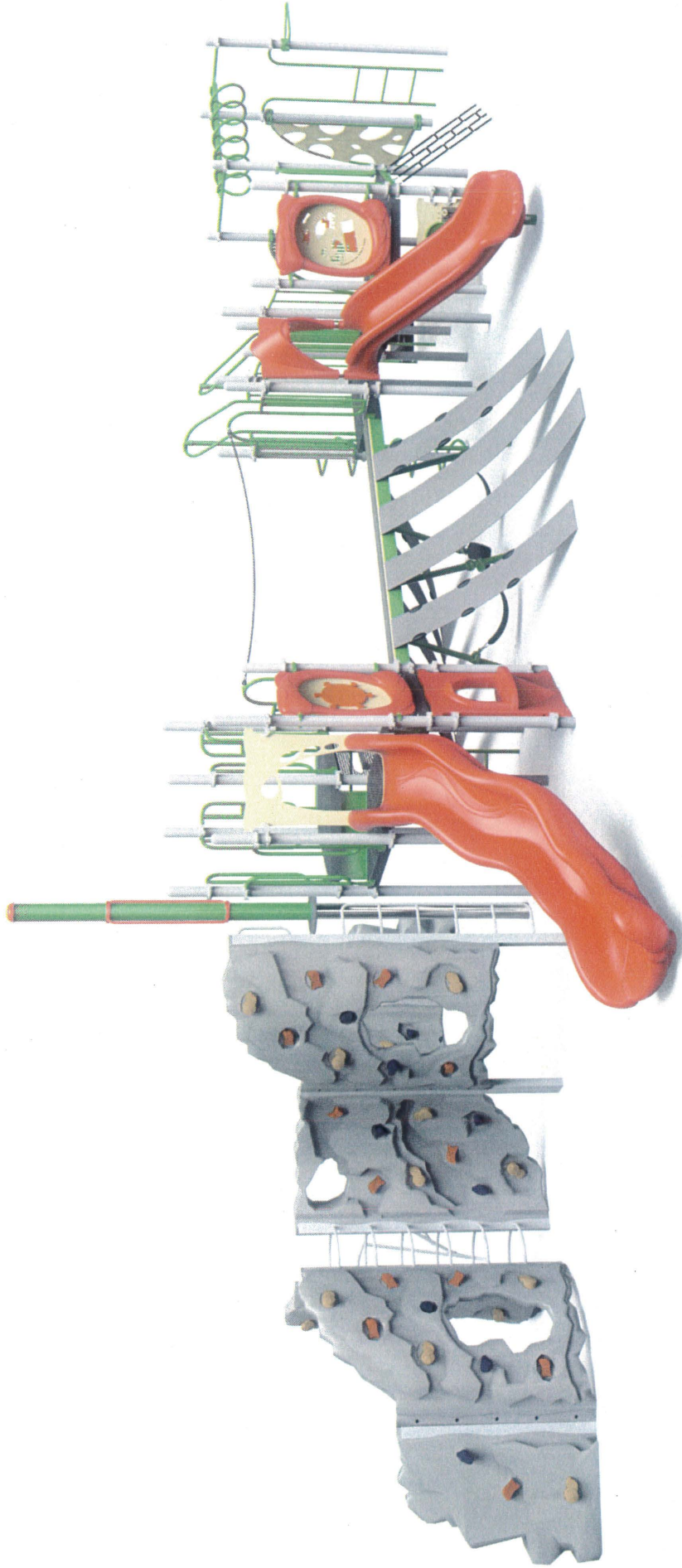



PLAYWORLD SYSTEMS, INC.
 1000 Buffalo Road
 Lewisburg, PA
 17837-9795 USA

EQUIPMENT SIZE:
49'4" x 25'0" x 14'9"
 15,04M x 7,62M x 4,5M

USE ZONE:
61'7" x 37'2"
 18,77M x 11,33M

AREA: **1696 SqFt.** PERIMETER: **161 Ft.**
 157,56 SqM. 49,07M

FALL HEIGHT:
9 Ft.
 2,75M

USER CAPACITY: **88** AGE GROUP: **5-12**

ADA SCHEDULE	Total Elevated Play Activities: 13		
	Total Ground-Level Play Activities: 5		
	Accessible Elevated Activities	Accessible Ground-Level Activities	Accessible Ground-Level Play Types
Required	7	4	3
Provided	8	5	4

- ✓ ASTM F1487-17
- ✓ CPSC #325



PROJECT NO: **350-1705B** SCALE: **3/16"=1'-0"**

DRAWN BY: **M. MERTZ** Paper Size

DATE: **14-DEC-18** **B**

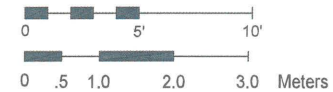
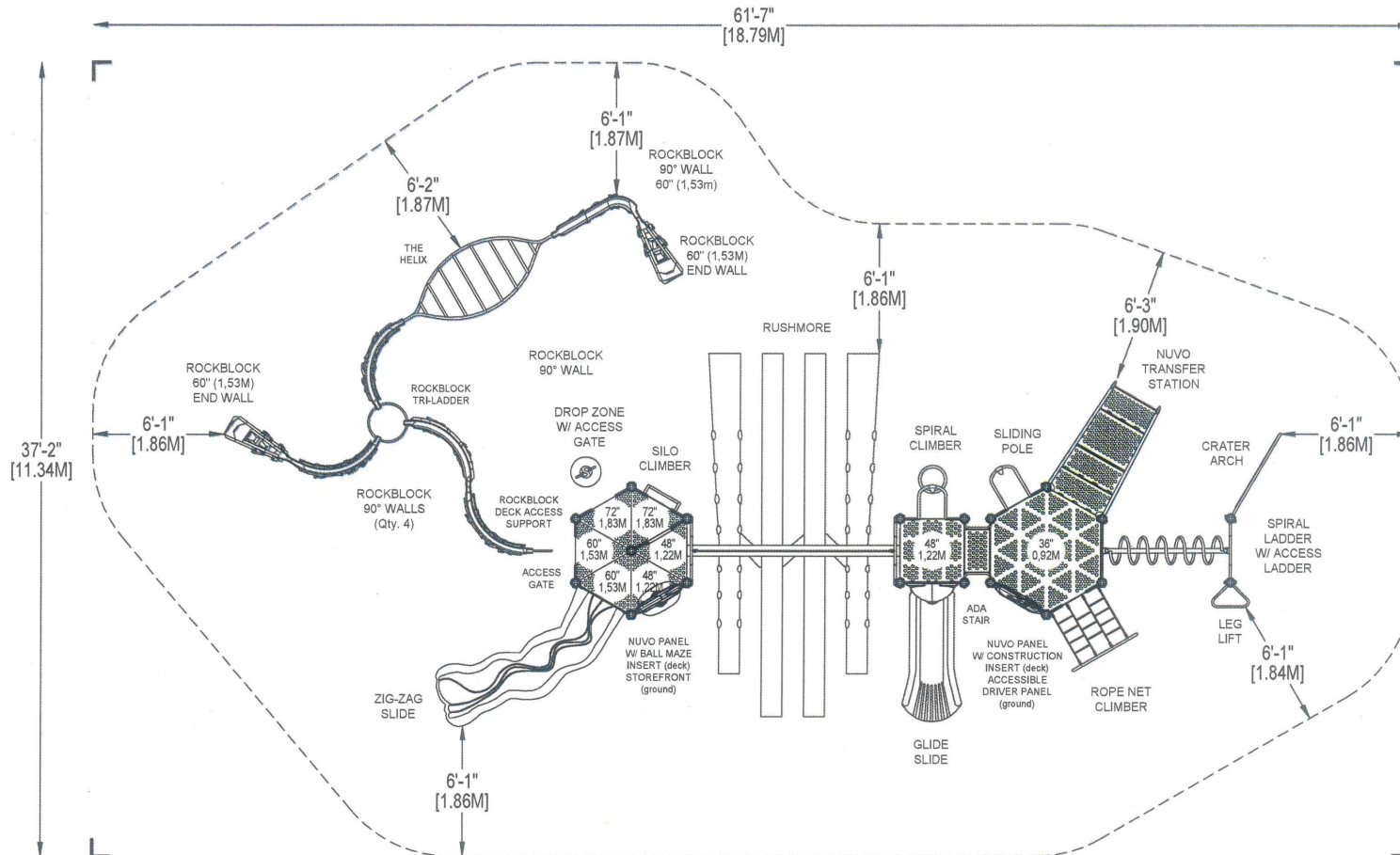

*PLAYGROUND SUPERVISION REQUIRED

CANYON'S CROSS
 CATALOG PRE-DESIGN

City Of Wasilla
 Capital Improvement Project Detail
 Fiscal Year 2020
 Through Fiscal Year 2023

Project Title:

Project Number:
 (Assigned By Finance Department)

Project Description:

Department/Div.:

Ranking:
 (Assigned By Administration)

Project Narrative:

This project will install a new playground at the Lucile Creek Trail Head next to the Menard Center.



Impact on Operating Budget:

None

Project Cost Summary

Expenditure Category:

	Prior Budget	Project Expenditures To Date	Project Balance	Additions				Total CIP Cost
				Fiscal YR 2020	Fiscal YR 2021	Fiscal YR 2022	Fiscal YR 2023	
Administration/OH	\$ -	\$ -	\$ -	\$ -	\$ -	\$ -	\$ -	\$ -
Land	-	-	-	-	-	-	-	-
Design Services	-	-	-	-	-	-	-	-
Engineering	-	-	-	-	-	-	-	-
Construction	-	-	-	75,000	-	-	-	75,000
Equipment	-	-	-	-	-	-	-	-
Other Services	-	-	-	-	-	-	-	-
Contingency	-	-	-	-	-	-	-	-
Totals	\$ -	\$ -	\$ -	\$ 75,000	\$ -	\$ -	\$ -	\$ 75,000

Funding Source Summary

Funding Sources:

	Prior Budget	Project Revenue To Date	Project Balance	Additions				Total CIP Funding
				Fiscal YR 2020	Fiscal YR 2021	Fiscal YR 2022	Fiscal YR 2023	
Local:								
Operating Transfers								
General Fund	\$ -	\$ -	\$ -	\$ 75,000	\$ -	\$ -	\$ -	\$ 75,000
Totals	\$ -	\$ -	\$ -	\$ 75,000	\$ -	\$ -	\$ -	\$ 75,000

Cost Beyond 5-Year

Program: