

Council Action: Approved: <input checked="" type="checkbox"/> Denied: <input type="checkbox"/>
Date of Action: 10/14/19
Verified by: <i>[Signature]</i>

CITY COUNCIL ACTION MEMORANDUM

AM No. 19-45: Contract Amendment To HDL Engineering Consultants In The Amount Of \$51,356 For The Wasilla Airport Gate A Access Control Improvements Project Construction Administration Services.

Originator: Public Works Director
 Date: September 25, 2019

Agenda of: October 14, 2019

Route to:	Department Head	Signature	Date
X	Public Works Director	<i>[Signature]</i>	9/25/19
X	Finance Director	<i>[Signature]</i>	9/25/19
X	Deputy Administrator	<i>[Signature]</i>	9/25/19
X	City Clerk	<i>[Signature]</i>	9/25/19

Reviewed by Mayor Bert L. Cottle: *[Signature]* 9/25/2019

Fiscal Impact: yes or no **Funds Available:** yes

Account name/number: Gate A Security Imp-FAA/330-4379-437.45-23 \$48,146
 Gate A Security Imp-Match/330-4379-437.45-30 \$3,210

Attachments: HDL Proposal (2 pages)
 Project Diagrams (4 pages)

Summary Statement: This is a continuation of HDL Engineering Consultants term contract for airport design and construction administration services. HDL Engineering Consultants provided the Gate A Security Improvements design and grant assistance earlier this year. The project was advertised, bid and approved by FAA for grant funding.

This project will install approximately 900 linear feet of fiber optic cable from the existing system at Gate C and extending it to Gate A connecting to the City’s control management system at the airport. A new fiber optic distribution panel will be installed at Gate A to allow the gate to be programed by city staff. This contract amendment provides the necessary inspection and project oversight to meet FAA requirements. This contract has been approved by FAA for grant funding in the amount outlined.

Staff Recommendation: Approve contract amendment to HDL Engineering Consultants in the amount of \$51,356 for the Wasilla Airport Gate A Access Control Improvements project construction administration services.

FIRM: HDL Engineering Consultants, LLC.	PROJECT TITLE: Wasilla Airport Gate A Access Control Improvements	DATE: 8/20/2019
--	---	------------------------

TOTAL NEGOTIATED FIXED FEE: N/A

GROUP	TASK	LABOR (or FP)	INDIRECT COST	EXPENSES	TOTAL COST	FEE DISTRIBUTION	FIRM'S TOTAL PRICE	*SUB- CONTRACTS	PRICE PLUS SUBS
0	1	\$41,780	\$0	\$1,848	\$43,628		\$43,628	\$7,728	\$51,356

*Subcontractors for negotiated professional or technical services, products, etc. (Commodity items available to the general public at market prices, equipment use, and unit priced items are generally included in estimate as expenses.)

ESTIMATED TOTALS	LABOR (or FP)	INDIRECT COST	EXPENSES	TOTAL COST	FEE	FIRM'S TOTAL PRICE	*SUB- CONTRACTS	PRICE PLUS SUBS
FOR FIRM:	\$41,780	\$0	\$1,848	\$43,628	\$0	\$43,628	\$7,728	\$51,356

COST ESTIMATE PER TASK

FIRM: HDL Engineering Consultants, LLC.			PROJECT TITLE: Wasilla Airport Gate A Access Control Improvements								
TASK NO:	1	TASK DESCRIPTION: PS&E preparation							DATE:	8/20/2019	
GROUP:		METHOD OF PAYMENT: FP <input type="checkbox"/> FPPE <input type="checkbox"/> T&E <input checked="" type="checkbox"/> CPFF <input type="checkbox"/>					PREPARED BY: Shawn Hull				
SUB-TASK NO.	SUB-TASK DESCRIPTION	LABOR HOURS PER JOB CLASSIFICATION									
		Contract Manager	Project Manager	Civil Engineer	Eng. Assistant/Inspector	Drafter	Clerical				
	Management & Coordination	4	4				4				
	Weekly Meetings		10	10							
	Submittal & Shop Drawing Review		2	4							
	Project Administration (7 weeks)		28	56							
	Part-Time Inspection Services (7 weeks) (Assumes 4 hours per day)				168						
	Construction Start/End Inspections		4	16	16						
	Construction Completion and Closeout (EDC to complete record drawings)	2	4	16	4						
TOTAL LABOR HOURS		6	52	102	188	0	4	0	0	0	0
* LABOR RATES (\$/HR)		\$180.00	\$160.00	\$130.00	\$100.00	\$110.00	\$80.00				
LABOR COSTS (\$)		\$1,080	\$8,320	\$13,260	\$18,800	\$0	\$320	\$0	\$0	\$0	\$0
EXPENSES											
SUB-TASK NO.	ITEM(S)	QUANTITY	UNIT PRICE	TOTAL PRICE	COMMENTS: Assumes: - 7 weeks of construction - Part-time inspection at 4 hours per day - See EDC's fee proposal dated August 6, 2019						
	Vehicles (Half Days)	42	\$40.00	\$1,680.00							
				\$0.00							
				\$0.00							
				\$0.00							
				\$0.00							
				\$0.00							
	Markup at 10%			\$168.00	FIRM'S TOTAL COST OF LABOR (or Fixed Price):		\$41,780				
				TOTAL EXPENSES:	\$1,848	IF CPFF, TOTAL INDIRECT COST @		0.00%	\$0		
SUB-CONTRACTORS: Firm Initials and Price Per Task					FIRM'S TOTAL EXPENSES		\$1,848				
					FIRM'S TOTAL COST (no Subcontracts or Fee)		\$43,628				
FIRM:	EDC			Subtotal	10% Markup	TOTAL SUBCONTRACTOR PRICES:		\$7,728			
AMOUNT:	\$7,025			\$7,025	\$703						

* Labor Rates shall be direct labor (base pay) only if Method of Payment is CPFF; otherwise, Labor Rates shall be total rates (i.e. base pay + benefits + overhead + profit.)

H:\WORK\19-019-Wasilla Airport Engineering Term (COV)\04-Security Equip-Perimeter Fencing Design\CAD Drawings\19019_04_01.1_1=700_04/23/14 at 07:56 by unknown
 C:\Users\jacobson\Documents\CAD\19019_04_01.1_1=700_04/23/14 at 07:56 by unknown
 FILEPATH: H:\WORK\19-019-Wasilla Airport SECURITY, PH II (COV)\CAD Drawings\19019_04_01.1.DWG

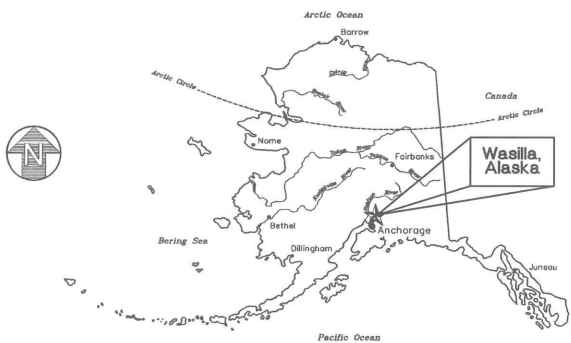

LOCATION MAP

WASILLA MUNICIPAL AIRPORT

GATE A ACCESS CONTROL IMPROVEMENTS

AIP NO. 3-02-0417-022-2019

WASILLA, ALASKA

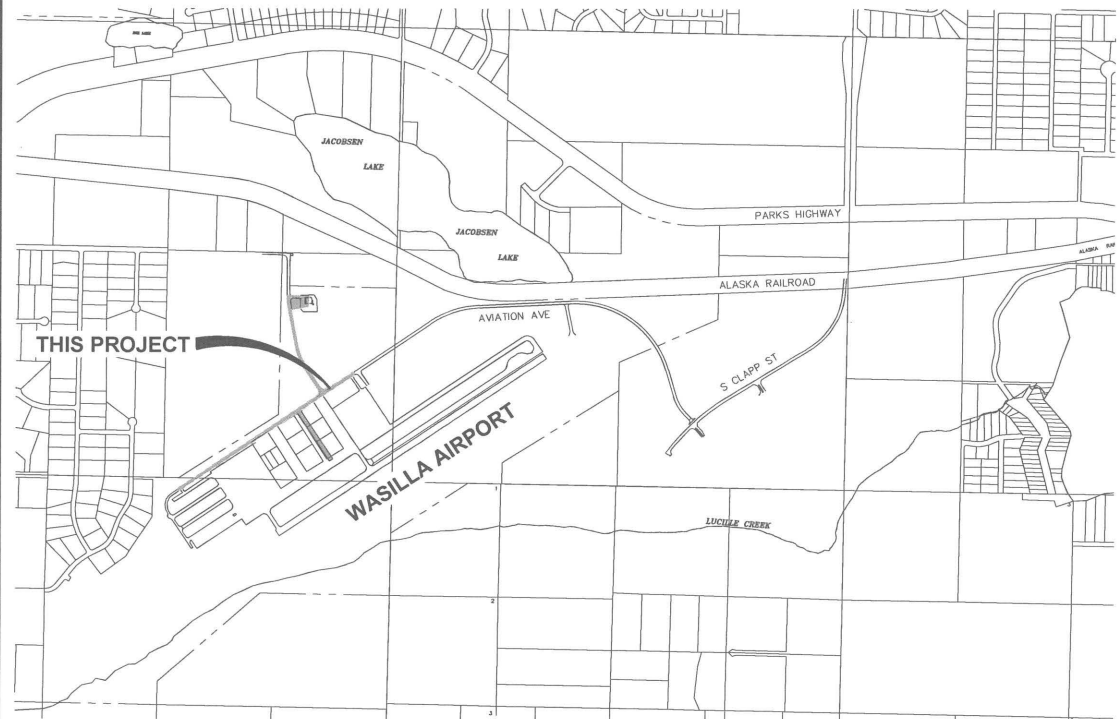

VICINITY MAP

DRAWING INDEX

- G1.1 COVER SHEET
- G1.2 PROJECT LAYOUT AND SAFETY PLAN
- E1.1 LEGENDS, ABBREVIATIONS AND SITE PLAN
- E2.1 GATE A ELECTRICAL PLAN
- E3.1 NETWORK ARCHITECTURE MODIFICATIONS
- E4.1 DETAILS
- E5.1 GATE CONTROLLER SUPPORT BOX

REVISION	DATE	BY	CHKD
1			
2			
3			
4			
5			



HDL ENGINEERING
Consultants LLC
 civil - geotechnical - surveying - environmental - natural history
 ANCHORAGE KENAI
 907.564.2120 907.283.2051
 3338 Arctic Boulevard, Suite 100 Anchorage, AK 99503
 www.hdlconsult.com

WASILLA AIRPORT GATE A ACCESS CONTROL IMPROVEMENTS WASILLA MUNICIPAL AIRPORT WASILLA, ALASKA	
SHEET TITLE COVER SHEET	
SHEET G1.1	
DRAWN BY: 75	CHECKED BY: []
DATE: JUNE 2019	SCALE: N/A
SHEET NUMBER: 19-019	



REVISION	DATE	DESCRIPTION
1		
2		
3		
4		
5		



HDL ENGINEERING Consultants LLC
 civil - geotechnical - surveying - environmental - material testing
 ANCHORAGE MAT-SLU KENAI
 907.562.2720 907.283.2051
 3335 Arctic Boulevard, Suite 100 Anchorage, AK 99503
 www.HDL-engineering.com
 ALCC0081

PROJECT NOTES:

1. ALL CONSTRUCTION TO BE COMPLETED IN ACCORDANCE WITH THE PROJECT MANUAL TITLED "WASILLA MUNICIPAL AIRPORT GATE A ACCESS CONTROL IMPROVEMENTS", DATED JULY 2019.
2. OTHER CONTRACTORS OR UTILITY COMPANIES MAY BE WORKING ON THE SAME PROJECT SITE OR IN THE VICINITY DURING THE PROGRESS OF THIS CONTRACT'S WORK. CONTRACTOR SHALL COORDINATE HIS WORK WITH ALL OTHER CONTRACTORS OR UTILITY COMPANIES WORKING AT OR NEAR THE AIRPORT.
3. CONTRACTOR SHALL COMPLY WITH THE REQUIREMENTS OF THE INTERNATIONAL BUILDING CODE, STATE AND FEDERAL OCCUPATIONAL SAFETY AND HEALTH ADMINISTRATIONS (OSHA), AND ALL OTHER FEDERAL, STATE, AND LOCAL LAWS AND REGULATIONS PERTAINING TO THIS PROJECT. ANY WORK PERFORMED BY THE CONTRACTOR CONTRARY TO SUCH LAWS OR REGULATIONS SHALL BE AT THE CONTRACTOR'S SOLE RISK AND EXPENSE.
4. THE CONTRACTOR SHALL PROVIDE ALL PERMITS WHICH ARE NOT SPECIFICALLY INDICATED AS PROVIDED BY THE OWNER IN THE PROJECT MANUAL.
5. CONTRACTOR SHALL VERIFY ALL DIMENSIONS AND LAYOUT PRIOR TO PROCEEDING WITH THE WORK. ANY DISCREPANCY IN THE PLANS SHALL BE BROUGHT TO THE ATTENTION OF THE ENGINEER PRIOR TO PROCEEDING WITH THE WORK.
6. EXISTING BURIED AND ABOVE GRADE UTILITIES ARE SHOWN IN THEIR APPROXIMATE LOCATIONS. NOT ALL UTILITIES ARE SHOWN ON DRAWINGS FOR CLARITY. NOT ALL UTILITY LOCATIONS HAVE BEEN FIELD VERIFIED AND NO GUARANTEE IS MADE AS TO THE ACCURACY OR COMPLETENESS OF THE UTILITY INFORMATION SHOWN. THE CONTRACTOR SHALL CONTACT LOCAL UTILITIES TO FIELD LOCATE ALL UTILITIES PRIOR TO DIGGING. ANY DISCREPANCIES SHALL BE BROUGHT TO THE ATTENTION OF THE ENGINEER PRIOR TO DIGGING, OTHERWISE CONTRACTOR IS RESPONSIBLE FOR ALL ADDITIONAL COSTS ASSOCIATED WITH WORKING AROUND UTILITIES DIFFERENT THAN WHAT IS SHOWN ON THESE PLANS.
7. IN ACCORDANCE WITH GENERALLY ACCEPTED CONSTRUCTION PRACTICES, THE CONTRACTOR SHALL HAVE SOLE AND COMPLETE RESPONSIBILITY FOR JOB SITE CONDITIONS DURING THE COURSE OF CONSTRUCTION OF THE PROJECT, INCLUDING SAFETY OF ALL PERSONS, SUBCONTRACTORS, SUPPLIERS, AND PROPERTY. THIS REQUIREMENT SHALL BE MADE TO APPLY CONTINUOUSLY AND NOT BE LIMITED TO NORMAL WORKING HOURS.
8. CONTRACTOR SHALL PROVIDE MARKED UP RECORD DRAWINGS INCLUDING TWO COPIES OF THE CONSTRUCTION SURVEY NOTES SHOWING ALL ASBUILT INFORMATION.
9. A SITE SPECIFIC GEOTECHNICAL INVESTIGATION WAS NOT CONDUCTED DURING THE DESIGN OF THIS PROJECT.

WORK AREA RESTRICTIONS

WORK IS PERMITTED BETWEEN 7AM TO 7PM, 7 DAYS A WEEK. NO RESTRICTIONS TO AIR OPERATIONS AREAS ARE ALLOWED.

GENERAL SAFETY REQUIREMENTS

1. CONTRACTOR SHALL PAY PARTICULAR ATTENTION TO AND SHALL COMPLY WITH THE PROJECT SPECIFICATIONS AND FAA AC 150/5370-2F OPERATIONAL SAFETY ON AIRPORTS DURING CONSTRUCTION.
2. CONTRACTOR SHALL KEEP ACTIVE PAVED SURFACES CLEAR OF CONSTRUCTION MATERIALS, FOREIGN OBJECTS, DIRT, GRAVEL AND DEBRIS. REMOVE MATERIALS FROM ACTIVE PAVED SURFACES WITHIN 15 MINUTES OF VERBAL NOTICE FROM THE AIRPORT MANAGER, OR HIS REPRESENTATIVE.
3. CONTRACTOR SHALL NOT ENTER APRON WITHOUT PRIOR ARRANGEMENT WITH THE ENGINEER.
4. CONTRACTOR SHALL MONITOR CTAF ON 122.8 MHZ AT ALL TIMES WHEN WORKING ON AIRPORT.
5. CONTRACTOR SHALL NOT PARK EQUIPMENT ON BEACON STREET, CROSSWIND COURT, OR IN PUBLIC PARKING OVERNIGHT.

WASILLA AIRPORT GATE A ACCESS CONTROL IMPROVEMENTS
 WASILLA MUNICIPAL AIRPORT
 WASILLA, ALASKA

SHEET TITLE	
PROJECT LAYOUT AND SAFETY PLAN	
SHEET NO.	G1.2
DRAWN BY	TS
CHECKED BY	
DATE	JUNE 2019 (AS SHOWN)
SCALE	19-019

AUTHOR: TORREY
 LAYOUT DATE: SAFETY PLAN-6/16/2019 11:00 AM
 FILEPATH: H:_2019\19-019 WASILLA AIRPORT SECURITY, PH I (CONV)\DRAWINGS\190119_01_21.DWG

P:\Projects\VDI\wasilla_airport_security_improvements\Draws\Site\1.1 LEGENDS, ABBREVIATIONS AND SITE PLAN.dwg 2019-06-27 11:20:06

ELECTRICAL LEGEND

SYMBOL	DESCRIPTION
—	EXPOSED CONDUIT
----	UNDERGROUND CONDUIT
— — —	FIBER OPTIC CABLE
— — —	UNDERGROUND GAS LINE
→⊕	3/4" X 10' COPPER CLAD STEEL GROUND ROD
— — —	UNDERGROUND ELECTRIC
— — —	OVERHEAD ELECTRIC
⊕	KILOWATT-HOUR METER
□	PANEL BOARD
⊕	MOLDED CASE CIRCUIT BREAKER, X = AMPERE RATING, Y = NO. OF POLES
⊕	JUNCTION BOX, TYPE AS NOTED

OTHER SYMBOLS ARE AS DEFINED BY NOTE.

ELECTRICAL ABBREVIATIONS

Ø	DIAMETER, PHASE	L	LINE (CONDUCTOR, VOLTAGE)
A	ANALOG SIGNAL, AMPERE	LT	LEFT
AFF	ABOVE FINISH FLOOR	LTF	LIQUID TIGHT FLEXIBLE CONDUIT (METALLIC)
AFG	ABOVE FINISH GRADE	LTG	LIGHTING
ATS	AUTOMATIC TRANSFER SWITCH	MDP	MAIN DISTRIBUTION PANEL
BCU	BARE COPPER	MLO	MAIN LUG ONLY
BLDG	BUILDING	N	NEUTRAL (GROUNDED) CONDUCTOR
C	CONDUIT	NEG	NEGATIVE
CB	CIRCUIT BREAKER	NIC	NOT IN CONTRACT
CKT	CIRCUIT	NFS	NON-FROST SUSCEPTIBLE
CL	CENTERLINE	NLT	NOT LESS THAN
COW	CITY OF WASILLA	PR	PAIR
CP	CONTROL PANEL	R	RADIUS, RED
CU	COPPER	RT	RIGHT
DEG	DEGREES	SREB	SNOW REMOVAL EQUIPMENT BUILDING
E	EMERGENCY	SS	STAINLESS STEEL
G	GROUND CONDUCTOR	STA	STATION
GRC	GALVANIZED RIGID (STEEL) CONDUIT	TS	THERMOSTAT / TEMPERATURE SWITCH
GRD	GROUND	TWSH	TWISTED WIRE SHIELDED CONDUCTOR
H	HOT CONDUCTOR	TYP	TYPICAL
HDPE	HIGH DENSITY POLYETHYLENE CONDUIT	UON	UNLESS OTHERWISE NOTED
HH	HANDHOLE	V	VOLTS
HOA	HAND-OFF-AUTO	VA	VOLT-AMPERES
J-BOX	JUNCTION BOX	W	WIRE, WATTS, WHITE
KV	KILO-VOLT	WP	WEATHERPROOF
KVA	KILO-VOLT-AMPERES	XFMR	TRANSFORMER

GENERAL NOTES

- ALL ELECTRICAL WORK SHALL BE INSTALLED IN ACCORDANCE WITH THE PROJECT SPECIFICATIONS, CODES AND STANDARDS GOVERNING THE PROJECT. IF PLANS AND SPECIFICATIONS ARE IN DIRECT CONFLICT, THE MORE STRINGENT REQUIREMENTS SHALL GOVERN.
- EXISTING BELOW GRADE CIRCUITS AND UTILITIES ARE SHOWN IN APPROXIMATE LOCATIONS. ADDITIONAL BELOW GRADE CIRCUITS MAY EXIST AND ARE NOT SHOWN. WHERE SINGLE LINES ARE SHOWN MULTIPLE LINES MAY BE ENCOUNTERED, SINGLE LINES WERE SHOWN FOR CLARITY. CONTRACTOR SHALL FIELD LOCATE ALL UNDERGROUND ELECTRIC CABLES & UTILITIES PRIOR TO DIGGING. HAND DIG WITHIN 36" OF ALL BURIED ELECTRIC.
- NEW FIBER OPTIC ROUTING IS SHOWN GENERALLY. INTENT IS FOR NEW FIBER OPTIC CABLE IN CONDUIT TO BE INSTALLED ALONG THE SHOULDER OF AVIATION AVE. IN GRASS/GRAVEL AREA. CONTRACTOR MAY MAKE MINOR DEVIATIONS FROM ROUTING SHOWN OR PROPOSE ALTERNATIVE ROUTING; DEVIATIONS AND ALTERNATIVE ROUTES SHALL BE AT NO ADDITIONAL EXPENSE TO THE OWNER.
- STAKE PROPOSED FIBER OPTIC CABLE ROUTING IN THE FIELD AND REQUEST APPROVAL FROM THE ENGINEER. DO NOT BEGIN EXCAVATION UNTIL FIBER OPTIC CABLE ROUTING HAS BEEN APPROVED BY THE ENGINEER.

SHEET NOTES

- EXISTING FIBER DISTRIBUTION PANEL 'DP5'. EXTEND FIBER TRUNK FROM 'DP5' TO NEW 'DP4' AT GATE 'A'. SEE SHEET E3.1 FOR FIBER NETWORK ARCHITECTURE.
 - EXISTING GATE 'A' POWER CIRCUITS ORIGINATE AT PANEL 'MDP'. DEMOLISH EXISTING CONDUCTORS AND PROVIDE NEW IN EXISTING CONDUIT. EXISTING CIRCUIT BREAKERS TO REMAIN FOR REUSE. SEE SHEET E2.1 FOR NEW WORK DETAILS.
 - EXISTING BELOW GRADE CONDUIT WITH ABANDONED 1PR#18 AND 2PR#18 CABLES.
- Ⓧ SEE ELECTRICAL EQUIPMENT SCHEDULE SHEET E3.1
- ① SEE CIRCUIT SCHEDULE SHEET E2.1

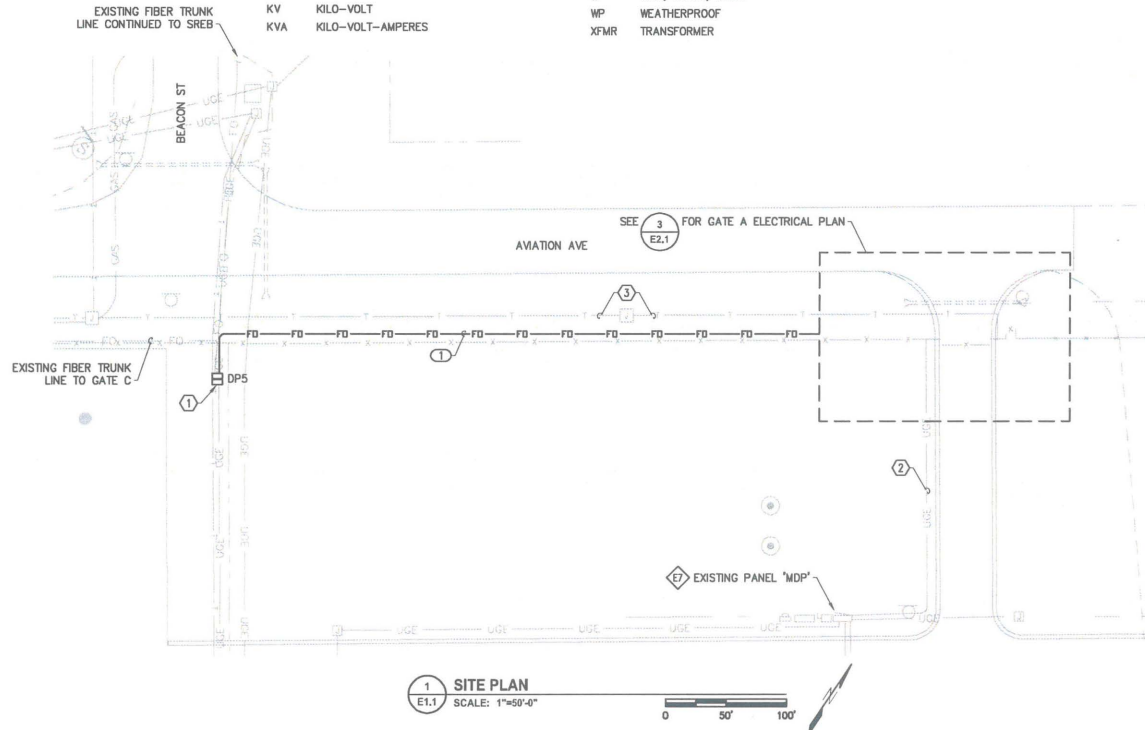

NO.	REVISION	DATE
1		
2		
3		
4		
5		



EDC, INC.
213 W. FIREWEED LANE
WASILLA, AK 99603
(907) 274-7853
LICENSE NO. AEC0705



GATE A ACCESS CONTROL IMPROVEMENTS
WASILLA MUNICIPAL AIRPORT
WASILLA, ALASKA

SHEET TITLE	
LEGENDS, ABBREVIATIONS AND SITE PLAN	
SHEET E1.1	
Drawn by: CW, OM	Checked by: RNP
DATE: 6/27/19	SCALE: SHOWN
SHEET NUMBER: 19-019	

P:\Projects\100\Vehicle airport security improvements\Drawings\E2.1 GATE A ELECTRICAL PLAN.dwg 2019-06-27 11:20:13

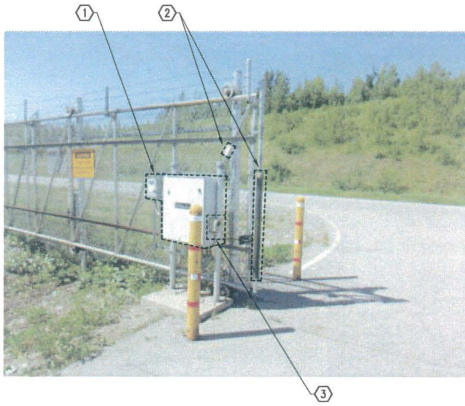

1 GATE A OPERATOR PHOTO
E2.1 SCALE: NTS



2 GATE A SUPPORT BOX PHOTO
E2.1 SCALE: NTS

ELECTRICAL EQUIPMENT SCHEDULE		
ITEM NO.	DESCRIPTION	MANUFACTURER OR EQUAL
E1	1HP, 208V, 3Ø GATE OPERATOR	LIFTMASTER CAT# SL595UL
E2	30A, 208V, 3PST, NON-FUSIBLE DISCONNECT SWITCH	SQUARE D
E3	120V, 1Ø GATE CONTROL SUPPORT BOX	
E4	NEMA 4X, STAINLESS STEEL FIBER DISTRIBUTION PANEL ENCLOSURE - SEE ITEMS E5 AND E6 BELOW	HOFFMAN
E5	FIBER CONNECTOR HOUSING, WALL-MOUNT	CORNING CAT# PWM-06P
E6	FIBER SPLICE HOUSING, WALL-MOUNT	CORNING CAT# WSH-11SPT-F
E7	EXISTING 400A, 208/120V, 3Ø, 4-WIRE DISTRIBUTION PANELBOARD 'MDP'	GE SPECTRA SERIES

CIRCUIT SCHEDULE	
TAG	DESCRIPTION
1	2" HOPE, 2 EACH: 24-STRAND FIBER OPTIC CABLE
2	EXISTING 2"C, NEW 3ØØ (H, N, G), NEW 4ØØ (3Ø, G)
3	EXISTING 1"C, NEW 3ØØ (H, N, G)

SHEET NOTES

- 1 DEMOLISH EXISTING GATE OPERATOR AND DISCONNECT SWITCH.
- 2 DEMOLISH EXISTING GATE EDGE SENSOR AND TRANSMITTER.
- 3 DEMOLISH EXISTING PHOTOEYES AND ASSOCIATED WIRING.
- 4 DEMOLISH EXISTING GATE CONTROL SUPPORT BOX AND ASSOCIATED WIRING.
- 5 DEMOLISH EXISTING MOTION SENSOR AND ASSOCIATED WIRING.
- 6 DEMOLISH EXISTING PUSHBUTTON STATION AND ASSOCIATED WIRING.
- 7 NEW GATE OPERATOR. INSTALL TO EXISTING FOUNDATION IN ACCORDANCE WITH MANUFACTURER'S INSTRUCTIONS; ADJUST FOUNDATION LOCATION RELATIVE TO GATE SUCH THAT GATE OPERATOR HAS ADEQUATE SPACE BETWEEN GATE. INSTALL NEW ANCHORS AS REQUIRED AND GROUT EXISTING ANCHOR HOLES SMOOTH. INSTALL NEW GATE EDGE SENSOR AND PHOTOEYE EQUIPMENT IN ACCORDANCE WITH MANUFACTURER'S INSTRUCTIONS.
- 8 NEW GATE CONTROLLER SUPPORT BOX. SUPPORT FROM EXISTING STEEL POST. SEE DETAIL 2 SHEET E4.1 FOR PERIPHERAL DEVICE ARRANGEMENT.
- 9 DEMOLISH EXISTING GATE OPERATOR AND GATE CONTROLLER POWER CIRCUITS. PROVIDE NEW CONDUCTORS IN EXISTING CONDUIT.
- 10 NEW FIBER DISTRIBUTION PANEL 'DP4'. SEE E3.1 AND E4.1 FOR DETAILS.
- 11 ROUTE 2" HOPE IN 4" GRC AT ALL ROAD CROSSINGS. SEE TRENCH DETAILS ON SHEET E4.1.
- 12 NEW GATE OPERATOR DISCONNECT SWITCH.
- 13 EXISTING BELOW GRADE CONDUIT AND TYPE 1A J-BOX WITH 1PR#18 AND 2PR#18 CABLES. LABEL CABLES AS ABANDONED AND LEAVE IN PLACE. DEMOLISH CONDUIT BETWEEN J-BOX AND GATE CONTROLLER SUPPORT BOX.
- 14 NEW CONTROL CONDUCTORS AS REQUIRED IN EXISTING 1" CONDUIT.

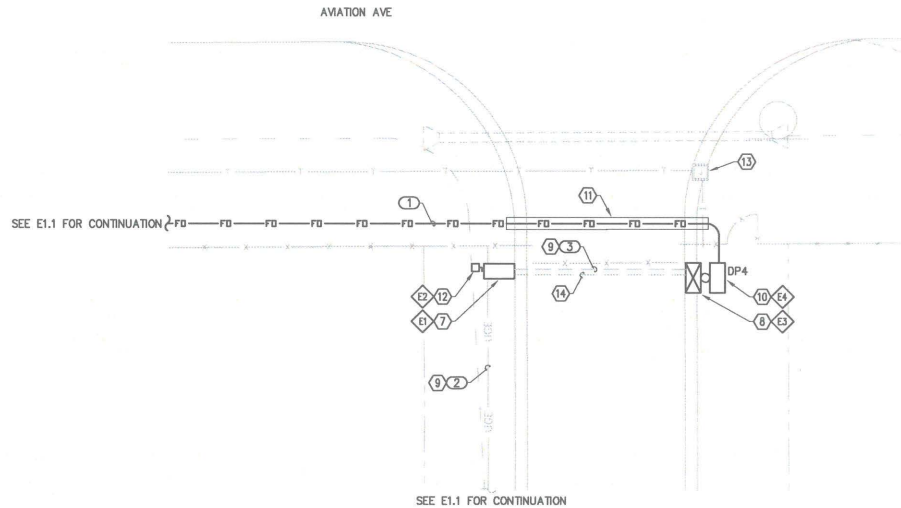

3 GATE A ELECTRICAL PLAN
E2.1 SCALE: 1"=10'-0"

REVISIONS	DATE	DESCRIPTION
1		
2		
3		
4		
5		



EDC, INC.
213 W. FIREWEED LANE
ANCHORAGE, AK 99503
PHONE: 907.562.1000
LICENSE NO. AEC0078



GATE A ACCESS CONTROL IMPROVEMENTS

WASILLA MUNICIPAL AIRPORT

WASILLA, ALASKA

GATE A ELECTRICAL PLAN

SHEET E2.1	
DESIGNED BY: CW, OM	CHECKED BY: RNP
DATE: 6/27/19	SCALE: SHOWN
JOB NUMBER: 19-019	