

Action: Approved | Denied | Other
 Date Action Taken: Feb. 22, 2021
 Verified By: *[Signature]*
 Clerk's Note: NA

**City of Wasilla
 Action Memorandum No. 21-13**

Contract Extension To Big Dipper Construction In The Amount Of \$62,000 For The Wastewater Treatment Plant Outfall Improvements Project.

Originator: Public Works Director
 Date: 2/10/2021

Agenda of: 2/22/2021

Route to:	Department Head	Signature	Date
X	Public Works Director	<i>[Signature]</i>	2/10/21
X	Finance Director	<i>[Signature]</i>	2-10-21
X	Deputy Administrator	<i>[Signature]</i>	2/10/21
X	City Clerk	<i>[Signature]</i>	2/10/2021
X	Mayor	<i>[Signature]</i>	2/10/21

Fiscal Impact: yes or no

Funds Available: yes \$62,000

Account name/number: Sewer Treatment Plant Impr/310-4359-435.45-35

Attachments: Big Dipper Proposal (2 pages)

Summary Statement: This contract extension is based on the contract awarded through Invitation to Bid No. 0426-0-2018/AG to Big Dipper Construction to construct the outfall improvements that includes one-half mile of outfall pipe, pipe diffusers, an access road, and gravel berm. The gravel berm has settled somewhat along its south portion and needs to have gravel added. This work needs to be done in March while the ground is still frozen to support heavy equipment. The berm provides access to sampling locations for field staff and provides a physical barrier to contain the wastewater discharge on property.

Staff Recommendation: Approve the Action Memorandum.



Big Dipper Construction Inc.

LICENSED • BONDED • INSURED
P.O. Box 874550 • Wasilla, Alaska 99687
Office: 376-8341 • Shop: 376-8340



Date: 1/22/2021

Big Dipper Construction Inc. proposes to furnish all supervision, labor, materials and equipment to address the peat settlement under the gravel berm crossing the swamp.

Description	Quantity	Unit	Unit Price	Total
Clearing and expanding at pit area	1	Lsum	\$ 4,500.00	\$ 4,500
Prep and widen berm for access	1	Lsum	\$ 7,686.00	\$ 7,686
Added seeding	0	Sqft	\$ 0.50	\$ -
Added SWPPP costs		Lsum	\$ 2,500.00	\$ -
Access road repairs and stabilization	1	Lsum	\$ 3,250.00	\$ 3,250
Temporary Facilities	1	Lsum	\$ 997.40	\$ 997
Additional grubbing and clean up	500	cyds	\$ 7.75	\$ 3,875
Additional structural material in wetland	2000	cyds	\$ 20.85	\$ 41,694
Total \$				62,002

Exclusions: Engineering, peat settlement, environmental impacts, and added infrastructure to roads accessing berm. This proposal is based on using the existing road/berm with lightly loaded rock trucks to stockpile material. Stockpiled material will be spread with lower impact equipment in wetland/swamp area.

Special Inclusions: This proposal is based on placing approx. 2000 cyds in the berm crossing the swamp. This quantity of material doesn't account for unknown peat settlement in this area.

Signature: _____

Date: _____

Terms: Invoices are due and payable within the 15th of receipt. A service charge of 18% per annum will be computed on all amounts overdue on regular statements dates.

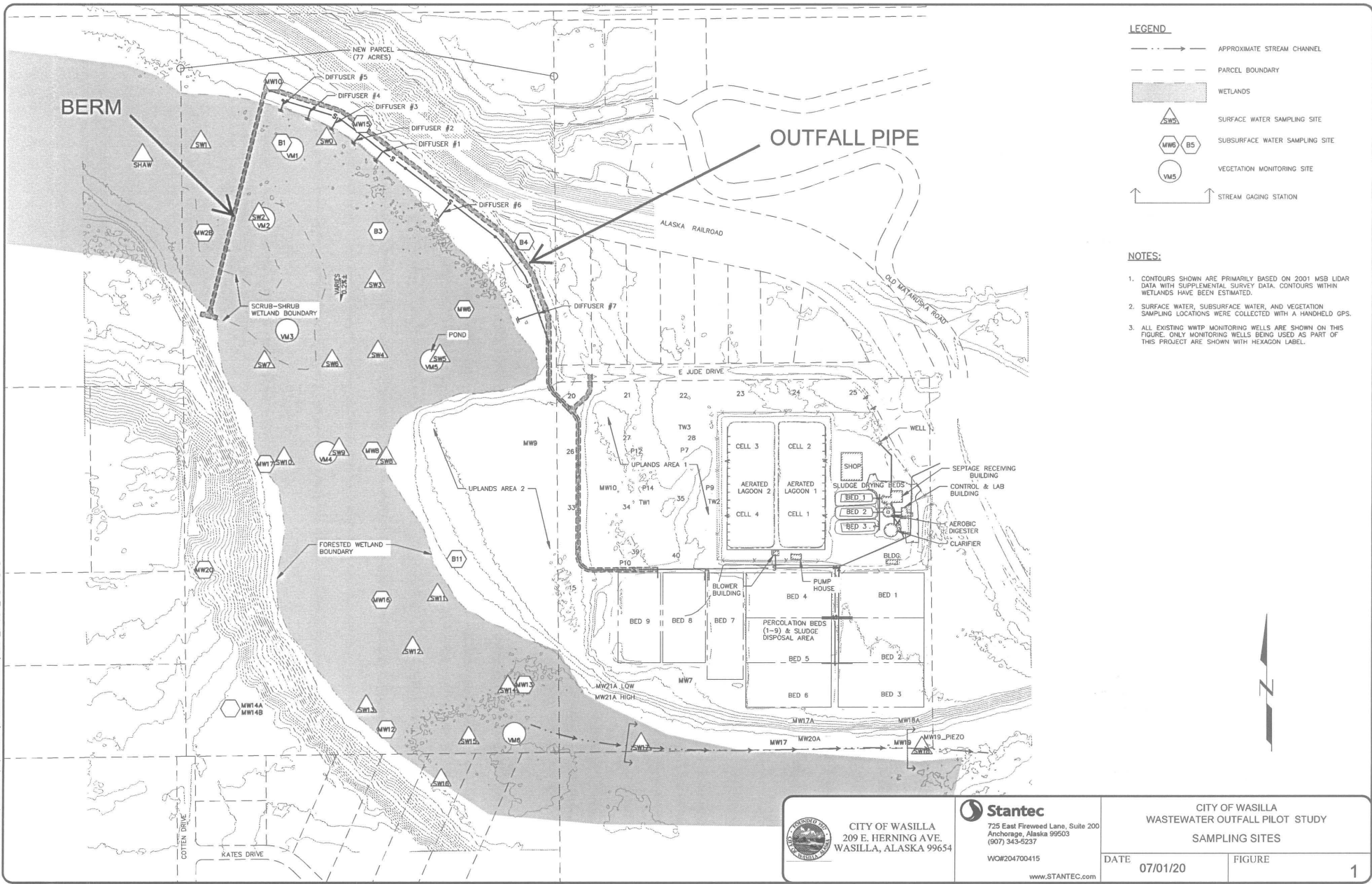

- LEGEND**
- APPROXIMATE STREAM CHANNEL
 - PARCEL BOUNDARY
 - WETLANDS
 - SURFACE WATER SAMPLING SITE
 - SUBSURFACE WATER SAMPLING SITE
 - VEGETATION MONITORING SITE
 - STREAM GAGING STATION

- NOTES:**
1. CONTOURS SHOWN ARE PRIMARILY BASED ON 2001 MSB LIDAR DATA WITH SUPPLEMENTAL SURVEY DATA. CONTOURS WITHIN WETLANDS HAVE BEEN ESTIMATED.
 2. SURFACE WATER, SUBSURFACE WATER, AND VEGETATION SAMPLING LOCATIONS WERE COLLECTED WITH A HANDHELD GPS.
 3. ALL EXISTING WWTP MONITORING WELLS ARE SHOWN ON THIS FIGURE. ONLY MONITORING WELLS BEING USED AS PART OF THIS PROJECT ARE SHOWN WITH HEXAGON LABEL.

J:\204700415\01\DATA\WWS\DISCHARGE\WPI01\B1\UD\Fig1.dwg
 2024/07/01 15:00:00

	CITY OF WASILLA 209 E. HERNING AVE. WASILLA, ALASKA 99654		CITY OF WASILLA WASTEWATER OUTFALL PILOT STUDY	
			SAMPLING SITES	
		WOI204700415 www.STANTEC.com	DATE 07/01/20	FIGURE 1