



	Approved	Denied
Date Action Taken:	✓	
Other:		
Verified by:	<i>Althaus</i>	

WASILLA CITY COUNCIL ACTION MEMORANDUM

AM No. 11-11

TITLE: CONTRACT AMENDMENT TO R&M CONSULTANTS IN THE AMOUNT OF \$176,100 FOR SWANSON AVENUE IMPROVEMENTS FINAL DESIGN, BIDDING, AND CONSTRUCTION ADMINISTRATION ENGINEERING SERVICES.

Agenda of: May 9, 2011
Originator: Public Works Director

Date: April 27, 2011

Route to:	Department	Signature/Date
X	Public Works Director	<i>[Signature]</i> 4/27/11
X	Finance Director	<i>[Signature]</i> 5/4/11
X	Temporary Deputy Administrator	<i>[Signature]</i> 5/4/11
X	City Clerk	<i>[Signature]</i>

REVIEWED BY MAYOR VERNE E. RUPRIGHT: *[Signature]*

FISCAL IMPACT: yes \$176,100 or no Funds Available yes

Account name/number: Swanson/Nelson 160-4320-432.45-59

Attachments: AM No. 10-32 (11 pages) and R&M Consultants April 20, 2011 Report (16 pages)

SUMMARY STATEMENT: The original contract award was authorized by City Council on December 13, 2010, through AM No. 10-32, to do preliminary engineering on both Nelson Avenue and Swanson Avenue, and to propose reconstruction options for portions of these roads. The priority right now is Swanson Avenue between Main Street and Crusey Street, and the attached report shows the different reconstruction options.

Option C will be used as it has lower maintenance costs and it will have less impact on neighboring properties. This contract amendment will provide the remainder of engineering services needed for Swanson Avenue. This project is being funded 100 percent with grant funds and is planned for construction this summer. Nelson Avenue from Lucille Street west 2,000 feet will be reconstructed next year.

STAFF RECOMMENDATION: Authorize contract amendment to R&M Consultants in the amount of \$176,100 for Swanson Avenue Improvements Final Design, Bidding, and Construction Administration Engineering Services.



	Approved	Denied
Date Action Taken:	12/1/10	
Other:	13	
Verified by:	<i>[Signature]</i>	

WASILLA CITY COUNCIL ACTION MEMORANDUM

AM No. 10-32

TITLE: CONTRACT AWARD TO R&M CONSULTANTS IN THE AMOUNT OF \$101,344 FOR SWANSON AND NELSON AVENUE IMPROVEMENTS ENGINEERING SERVICES.

Agenda of: December 13, 2010
Originator: Public Works Director

Date: December 1, 2010

Route to:	Department	Signature/Date
X	Public Works Director	<i>[Signature]</i> 12/1/10
X	Finance Director	<i>[Signature]</i> 12/1/10
X	Deputy Administrator	<i>[Signature]</i>
X	City Clerk	<i>[Signature]</i>

REVIEWED BY MAYOR VERNE E. RUPRIGHT: *[Signature]*

FISCAL IMPACT: yes \$101,344 or no Funds Available yes
Account name/number: Swanson/Nelson 160-4320-432.45-59
Attachments: RFP Summary and R&M Proposal

SUMMARY STATEMENT: A Request for Proposal (RFP) was issued by the City in August 2010. Five engineering proposals were received on September 17, 2010. A review committee evaluated the proposals and found R&M Consultants to be the number one ranked firm for this project. A cost proposal was then solicited based on a \$1.3 million total project budget. The initial contract will determine what options are available for the proposed budget. A second phase of this contract will be presented to City Council for final design, bidding, and construction management once these initial tasks are completed.

STAFF RECOMMENDATION: Authorize contract award to R&M Consultants in the amount of \$101,344 for Swanson and Nelson Avenue Improvements Engineering Services.

User: Giddings, Archie

Organization:

City of Wasilla

Logout | Help



My DemandStar Buyers Account Info

Log Bid [View Bids] Log Quote View Quotes Supplier Search Build Broadcast List Reports

Bid Details

Bid Information

EDIT

Agency City of Wasilla

Bid Type Request for Proposal

Bid Number RFP-0820-0-2010/AG

Fiscal Year 2010

Bid Writer Archie Giddings

Bid Name Swanson-Nelson Ave Improvements Engineering Services

Bid Status Under Evaluation

Bid Status Text Engineering Services

Award To

Due Date/Time 9/17/2010 2:00 PM Alaska

Broadcast Date 8/20/2010

Bid Bond

Project Estimated Budget

Plan (blueprint) Distribution Options None

Distribution Method Download and Mail

Distributed By Onvia DemandStar

Distribution Notes None

Scope of Work Engineering services to repave downtown streets 4,000 feet total length

E-Bidding No

Legal Ad

VIEW

Please select either the View or Edit button to manage legal ad.

Pre-Bid Conference

none

Publications

Anchorage Daily News 8/20/2010
Anchorage Daily News 8/23/2010

Documents

EDIT

Bid Package

- Request for Proposal (25 Pages, Complete)
- maps (2 Pages, Complete)
- Clarifications (1 Page, Complete)
- attachment (5 Pages, Complete)
- attachment (6 Pages, Complete)
- Clarification No. 2 (1 Page, Complete)

1. RFP GENERAL INFORMATION

The City of Wasilla (hereinafter referred to as the "City") is seeking proposals from qualified engineering firms to design and oversee construction of Swanson-Nelson Avenue Improvements. This project consists of rebuilding approximately 2,000 feet of Swanson Avenue between Main Street and Crusey Street and rebuilding approximately 2,000 feet of Nelson Avenue from Lucille Street west along Iditapark. The pavement is failing in these locations and storm drain improvements are needed as part of this project. It may be possible to tie Swanson Avenue catch basins into the Crusey Street storm drain system. Nelson Avenue does not have piped storm drain nearby.

The City reserves the right to enter into other professional contracts when deemed to be in its best interest. This Request for Proposal is restricted to the City only and proposals with respect to other agencies or projects will not be accepted. Any consulting firm licensed to conduct business in the State of Alaska may submit a proposal.

Firms interested in submitting a proposal to provide professional services shall provide evidence in their Statement of Qualifications that:

- 1.1. They have previous experience providing similar services for government entities.
- 1.2. They have staff and resources available to perform requested services as needed.
- 1.3. They are capable of performing required services on time.

2. ACRONYMS/DEFINITIONS

<i>Awarded Company</i>	The organization/individual that is awarded and has an approved contract with the City of Wasilla for the services identified in this RFP.
<i>City</i>	The City of Wasilla and any agency identified herein.
<i>City Staff</i>	Any City of Wasilla department head or their designee.
<i>Claims</i>	Damages, liability, losses, costs and expenses, court costs, reasonable attorneys' fees, including attorneys' fees incurred by the City in the enforcement of this indemnification obligation.
<i>Contractor</i>	Anyone who performs a service for the Proposer, in exchange for fees, but is not an employee of the Proposer's firm, agency, or business.
<i>Department</i>	Any City of Wasilla department, including the Office of the City Clerk, Finance, Public Works, Wasilla Police Department, etc.
<i>Evaluation Committee</i>	An independent committee comprised of a majority of City officers, employees and/or citizens established to evaluate and score proposals submitted in response to an RFP pursuant to WMC 5.08.120.
<i>Proposer</i>	A company submitting a proposal in response to this RFP.
<i>May</i>	Indicates something that is not mandatory but permissible.
<i>RFP</i>	Request for Proposal
<i>Shall/Must</i>	Indicates a mandatory requirement. Failure to meet a mandatory requirement may result in the rejection of a proposal as non-responsive.
<i>Should</i>	Indicates something that is recommended but not mandatory. If the Proposer fails to provide recommended information, the City may, at its sole option, ask

5.13. **Changes**

If a Proposer changes any material RFP language, Proposer's response may be deemed non-responsive.

5.14. **Licensing**

Proposers are cautioned that some services may contain licensing requirement(s). Proposers shall be proactive in verification of these requirements prior to proposal submittal. Proposals, which do not contain evidence of the Proposer's possession of the requisite licensure, may be deemed non-responsive.

6. PROPOSAL EVALUATION AND AWARD PROCESS

6.1. Proposals shall be consistently evaluated and scored on a 100 point scale in accordance with WMC 5.08.120 based upon the following criteria listed in descending order of precedence:

6.1.1. Key Personnel Experience – 50 points

Experience of key personnel including the number of years providing engineering services, education, professional certifications, number of years with the firm, and examples of similar projects.

6.1.2. Firm Experience – 30 points

Experience of the firm including number of years providing engineering services and examples of similar projects.

6.1.3. Quality of Proposal – 10 points

Based upon the written proposal of each firm. Is it clearly written? Does it conform to the stipulations of Section 4?

6.1.4. Geographic Location – 5 points

5 points will be assigned if project manager's office is within 25 radial miles of Wasilla City Hall, 4 points if within 50 radial miles, 3 points if within 75 radial miles, 2 points if within 100 radial miles, and 1 point if outside 100 miles.

6.1.5. Reference Questionnaire Responses – 5 points

Points will be awarded for each reference questionnaire received up to a maximum of two responses. 2.5 points for each positive questionnaire received will be awarded.

Proposals shall be kept confidential until a contract is awarded.

6.2. The City may notify finalists and request that they prepare for an oral presentation to the City of Wasilla. During the Oral Presentation, firms will have the opportunity to deliver a presentation based upon their proposal. The City will also prepare written questions that they might have for the vendor. These questions will be submitted to the vendor in advance and the vendor shall respond to these questions in writing and orally at the Oral Presentation. The City may also ask additional questions at the Oral Presentation and the finalists may be asked to provide their response in writing within five days of the conclusion of the Oral Presentation.



R&M CONSULTANTS, INC. (807) 522-1707, FAX (807) 522-3403, www.rmconsult.com
9101 Vanguard Drive, Anchorage, Alaska 99507

December 1, 2010

R&M No. 0001.00

Mr. Archie Giddings, P.E.
Public Works Director
City of Wasilla
290 E. Herning Avenue
Wasilla, AK 99654

RE: RFP No. 0820-0-2010/AG
Swanson-Nelson Avenues Improvements Engineering Services
Draft Scope-of-Work and Fee Proposal

Dear Mr. Giddings:

R&M Consultants, Inc. (R&M) appreciates the opportunity to provide professional services for designing roadway improvements to Swanson and Nelson Avenues for the City of Wasilla. This scope of work and fee proposal is based on a meeting between R&M and yourself on November 24, 2010. The proposed services are separated into the following initial tasks:

- Task 1 - Preliminary Engineering & Cost Estimating
- Task 2 - Design & ROW Surveys

Additional professional services to support final design tasks will be negotiated at a later date.

The scope of services for each task is generally described herein, and a Time & Expense (T&E) fee proposal is attached, estimating the amount of hours necessary to complete each task. Hourly rates are listed for each assigned labor category, based on an established multiplier which includes profit.

SCOPE-OF-WORK

Background: The City of Wasilla has approximately \$1.3 million dollars available to design and construct roadway improvements to both Swanson and Nelson Avenues. The City would like to have final plans completed so construction can begin in the spring/early summer of 2011. To that end, the City would like to start work on the project immediately, beginning with preliminary engineering and design surveys.

Task 1 - Preliminary Engineering & Cost Estimating: The objective of this task is to perform sufficient preliminary engineering to develop reasonable estimates of construction costs to determine the scope of the actual improvements. The planned scope of improvements include: upgrading the street structural section, removing the existing pavement and replacing with new AC pavement, and addressing immediate, known drainage issues (i.e., broken curb & gutter, lack of cut ditches or storm drain, low roadway profiles) as they contribute to street deterioration and

affect safety and maintenance. Additionally, the City would like to improve pedestrian facilities, in particular, the continuation of the AC paved pathway on the north side of Nelson from its termination to Lucille Street. Additional locations would be improved as budget permits.

The R&M effort will include a review of record and as-built drawings for the existing City street network, including, the recently completed Lucille Street and Crusey Street reconstruction projects. The preliminary engineering effort will focus on assessing the feasibility of tying the Swanson storm drain into the Crusey Street storm drain network, and taking collected roadway drainage along Nelson back to the sediment basin at Iditapark. Additional effort will include developing preliminary roadway quantities to assembly reasonable construction cost estimates. Quantities will be estimated using information (lengths, widths, etc.) obtained from record or as-built drawings. Construction cost estimates will be developed based on historical bid tabulations provided by City of Wasilla and DOT&PF bid tabulations. R&M will review recent cost escalation percentages to forecast 2011 unit prices.

City provided items. The City of Wasilla will provide the record or as-built drawings for the subject routes and adjacent streets, existing storm drain information, drawings, and bid tabulations.

R&M Deliverables. R&M will provide construction cost estimates and recommendations memo for improvements.

Once the scope of the actual project improvements has been determined, future design services and tasks will be determined and negotiated as amendments.

Task 2 - Design & ROW Surveys:

Swanson Avenue. R&M will perform surveying along Swanson Avenue beginning at the Swanson and Crusey Street intersection and proceeding to the Swanson and Main Street intersection, approximately 2,000 feet in length. The survey effort will collect existing topographical data (i.e., top back of curb, lip of curb, centerline, catch basin, etc) from back of sidewalk to back of sidewalk along the route at 100' intervals. Survey data will be collected only along centerlines for intersecting streets of Crusey and Main. Data collected for minor side streets will only consists of one or two shots at the radius returns to check drainage. Utility structures will be located at the surface only. Underground utility locates are not included.

Nelson Avenue. R&M will perform surveying along Nelson Avenue beginning at the Nelson and Lucille Street intersection and proceeding to the main driveway to the Iditapark, approximately 2,000 in length. The survey effort will collect existing topographical data (i.e. back of sidewalk, lip or curb, centerline, etc.) along the route at 100' intervals. Survey data will be collected only along centerline at the intersect of Lucille Street. Because Nelson Ave. has curb and gutter on only the north side, additional data collection to the south is necessary to correctly describe the existing ground in order to address drainage issues. Additional data is needed to determine outlet elevations at the sediment basin located within the Iditapark. Utility structures will be located at the surface only. Underground locates are not included.

ROW Surveys. R&M will perform a limited ROW survey, consisting of locating the property corners for one or two parcels at each end of both Swanson and Nelson Avenues, in order to define the general location of City ROW and tie the project.

R&M Deliverables. R&M will provide topographical information, digital terrain model (DTM) and base map drawings usable for final design.

Services Not Included:

The following services are not included under this scope of work and fee proposal. These may be added to the contract at the direction of the City.

- A complete ROW survey, capturing all property corners for all parcels adjacent to the Swanson and Nelson Avenue corridors;
- Environmental and Permitting;
- Public Involvement Activities, including preparing project communications (i.e. fact sheets, comment sheets or project updates) for posting to the City's website, attending additional meetings, or presenting the project to local business groups.

Additional Services:

At the City's option, May 2010 digital aerial photography may be purchased for both routes for an additional cost of \$800 (\$400 per route).

Please call if you have any questions or need additional clarification.

Very truly yours,
R&M CONSULTANTS, INC.



Lance W. DeBernardi, P.E.
Project Manager

Enclosures: Fee Proposal with hourly breakdowns

Cc: File

R&M CONSULTANTS, INC.

FIRM: R&M Consultants, Inc.		PROJECT: Swanson-Nelson Avenues Improvements						
Task: 1	DESC: Preliminary Engineering & Cost Estimating						DATE: 12/01/10	
SUB-TASK	SUB-TASK DESCRIPTION	LABOR HOURS PER JOB CLASSIFICATION						
		Contract Manager	Senior Engineer	Project Manager	Project Engineer	Staff Engineer	Clerical	
	Project Management	2		12				
	Research							
	Utilities drawings			2	4	8		
	Record / As-built drawings			2	4	8		
	Preliminary Engineering			16	24	55		
	Recommendation Memo			2	16	24	4	
	Review Meeting/Comments			8	4			
	Cost Estimate			4	8	16		
TOTAL LABOR HOURS		2	0	46	60	111	4	0
LABOR RATES (\$/HR)		\$243.43	\$143.50	\$162.80	\$115.63	\$84.44	\$83.68	
LABOR COSTS (\$)		\$486.86	\$0.00	\$7,488.80	\$6,937.80	\$9,372.84	\$334.72	\$0.00
EXPENSES					COMMENTS:			
Account Code	DESCRIPTION	QUANTITY	UNIT PRICE	TOTAL PRICE				
	R&M Vehicle	500	\$ 0.60	\$ 300.00				
	Reproductions	1000	\$ 0.25	\$ 250.00				
		0	\$ -	\$ -				
				\$ -				
				\$ -				
				\$ -				
				\$ -				
				\$ -				
TOTAL EXPENSES				\$ 550.00				
SUB-CONTRACTORS								
SUB-TASK	DESCRIPTION	FIRM	TOTAL PRICE					
			TOTAL LABOR \$ 24,621					
			TOTAL EXPENSES \$ 550					
			SUBCONTRACTORS \$ -					
			SUBCONTRACTORS MARK-UP \$ -					
			SUB-CONTRACTORS \$ -					
			TOTAL (NOT-TO-EXCEED) COST \$ 25,171					

**ENGINEERING RECOMMENDATION
MEMORANDUM**

**Swanson-Nelson Avenues Improvements
Swanson Avenue
PO 18831
Wasilla, Alaska**

**PREPARED FOR
CITY OF WASILLA
290 E. HERNING AVENUE
WASILLA, ALASKA 99654**

**PREPARED BY
R&M CONSULTANTS, INC.
9101 VANGUARD DRIVE
ANCHORAGE, ALASKA 99507**

R&M
R&M CONSULTANTS, INC.



April 20, 2011

R&M No. 1708.01

Mr. Archie Giddings, P.E.
Public Works Director
City of Wasilla
290 E. Herning Avenue
Wasilla, AK 99654

RE: Swanson Avenue Improvement Recommendations Memorandum
Swanson-Nelson Avenues Improvements Engineering Services
PO 18831

Dear Mr. Giddings:

At the City's direction R&M Consultants, Inc. (R&M) focused on completing the tasks identified per our Scope of Work dated December 1, 2010 for Swanson Avenue. To date we have completed the following:

- Task 1: Preliminary Engineering and Cost Estimating,
- Task 2: Design and ROW Survey.

Below is a description of our work efforts, results, and recommendations for improvements to Swanson Avenue.

Background: Roadway drainage along Swanson Avenue is currently conveyed via a network of curb and gutter (C&G), catch basins, storm drain manholes, buried pipes and three trenches under the roadway backfilled with porous material that functions as a French drain. The existing pavement shows signs of age and distress as evidenced with cracking, potholes, and a number of cold mix patches. There are discrete locations along Swanson Avenue between Yenlo Street and Crusey Street, where there is little to no roadway cross slope to facilitate drainage. Portions of the existing C&G are damaged visible by discontinuous flow lines, cracking, and broken segments. In general, the sidewalks remain functional with minimum widths. Pedestrian access at the intersections is available; however, it is non-continuous.

As part of the Alaska Department of Transportation and Public Facilities (DOT&PF) Crusey Street Improvement Project (STP-0001(259)/55006) constructed in 2006, a manhole and 75 feet of 24-inch pipe were installed to the west, under Swanson Avenue to accommodate a future storm drain tie-in (See Figure 1).

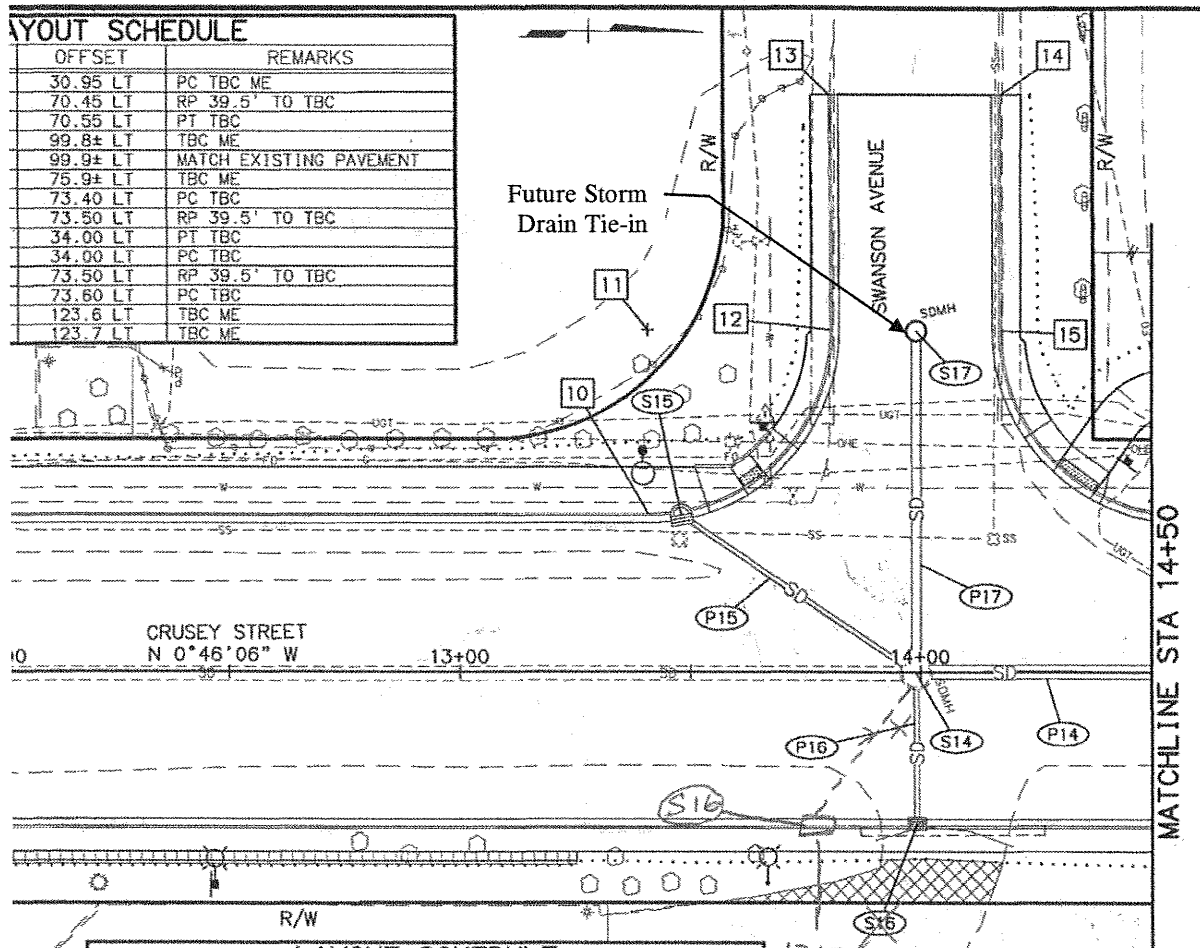

Figure 1 - Storm Drain System at the Intersection of Swanson Avenue & Crusey Street

A review of this tie-in (S17 & P17) reveals that the manhole and pipe do not permit a gravity connection without a significant grade raise to Swanson Avenue.

Hydrology: The Rational Method was used to determine the peak design runoff for a 10 year storm event. Peak flow occurs when the entire catchment acreage is contributing. The Rational Method is defined by the following equation:

$$Q = CIA$$

where:

Q = runoff, cfs

C = runoff coefficient

I = rainfall intensity, in/hr

A = drainage area, acres

Catchment area boundaries were estimated from the existing topographic divides. The contributing area is mostly Swanson Avenue, C&G, and sidewalk. This area is almost fully developed or impervious with the exception of the vegetative buffer strip between the curb and

the paved separated pathway adjacent to the middle school property. A drainage area of 2.6 acres was calculated. A runoff coefficient of C=0.9 was used for all impervious areas.

A 10 year storm event hyetograph was created by interpolating "Technical Paper 47- Probable Maximum Precipitation and Rainfall-Frequency Data for Alaska" figures 3-14,3-21,3-28,3-35,3-42,3-49, published by the Department of Commerce, Weather Bureau, 1963, to generate rainfall intensities using StormCAD.

Hydraulics: Estimated pipe flows were determined from a backwater analysis using StormCAD. Using Manning's equation pipe sizes and characteristics were determined.

$$Q = (1.48/n)AR^{2/3}S^{1/2}$$

where:

Q = runoff, cfs

A = cross sectional area, ft²

R = hydraulic radius, ft

S = slope of hydraulic grade line

n = Manning's coefficient

Given the 10 year design flow for the main 36" Crusey Street storm drain system, our 10 year design flow rate, the tentative location of inlets, drain pipes, and outfalls, R&M checked the capacity of the downstream storm drain system from the S14 towards Main Street.

Velocities and head losses were calculated for each pipe section and manhole. In order to reduce the amount of road being raised, a 300' section of pipe was designed with a 0% slope. During the 10 year design storm event, this pipe will flow full and the upstream manhole (MH-08 see attached plan and profile sheets) will become slightly surcharged. Contributing to the pipe flow depth is the backwater caused by the 10 year flow rates in the main 36" Crusey Street storm drain. As the level in the 36" Crusey Street storm drain settles so will the depth of flow in Swanson Avenue storm drain system.

Task 1 - Preliminary Engineering & Cost Estimating: The objective of this task is to perform sufficient preliminary engineering to develop reasonable estimates of construction costs for recommended roadway and drainage improvements. Per the City's direction, the general improvements include: repaving Swanson Avenue and approaches between Main Street and Crusey Street, replacing the existing drainage system with a new piped system between Yenlo Street and Crusey Street, and maintaining as much of the curb and sidewalk as possible.

R&M developed three options to improve drainage on Swanson Avenue by installing a storm drain system between Yenlo Street and Crusey Street that outlets into the Crusey Street storm drain system:

- Option A: Raise the roadway profile in the range of 6 to 8 feet to accommodate the installation of a new gravity flow storm drain system, with smooth walled pipes and slopes in the range of 1-2%. Key features of this alternative with significant cost implications include: substantial earthwork, increased traffic control challenges, driveway reconstruction, C&G and sidewalk replacement, utility relocation, and utility reconstruction.

- Option B: Maintain the existing roadway profile, construct a new gravity flow storm drain system and install a lift station to get drainage into the manhole and pipe tie-in identified (S17 & P17). This option maintains the existing profile but adds a maintenance and operations cost component estimated between \$10,000 and \$15,000 per year.
- Option C: Raise the roadway grade in the range of 1 to 3 feet and install a new gravity flow storm drain system with smooth wall pipes and slopes less than 0.5%. Key features of this alternative include: installing insulation board as the depth of bury is less than 4 feet; replacing the manhole (S17) and replacing the pipe run (P17) with approximately 300 feet of pipe at 0% slope; reconstructing approximately 1600 feet of C&G and sidewalk.
- Additional Alternative: Extend the storm drain system from Yenlo Street to Main Street.

Detailed cost estimates for each option are attached. Construction Engineering estimated at 15% is not included in the estimates.

Option C best meets the requirements and direction set out by the City of Wasilla.

Task 2 - Design & ROW Surveys:

Swanson Avenue. R&M completed the field survey and office work for Swanson Avenue in February of 2011. The field survey collected existing topographical data (i.e., top back of curb, lip of curb, centerline, catch basin, etc.) from back of sidewalk to back of sidewalk along the route at 100' intervals. Additional survey data was collected along centerlines for the intersecting streets of Crusey Street and Main Street, and minimal shots at the radius returns for minor side streets to check drainage. Utility structures were located at the surface only. Culvert inverts were surveyed only at the two manholes (S14 & S17) and pipes at the intersection of Swanson Avenue and Crusey Street. Underground utility locates were not included.

Topographical and digital terrain model (DTM) information usable for final design and preparation of base map drawings for plan set assemblies suitable for construction were prepared and attached.

Very truly yours,
R&M CONSULTANTS, INC.

Lance W. DeBernardi, P.E.
Project Manager

Enclosures: Cost Estimate
Preliminary Plan Sheets

Cc: File



ENGINEER'S ESTIMATE

CITY OF WASILLA

Swanson Avenue Basic Bid - Option A
 Raised Roadway With Gravity Flow S.D. System From Yenlo to Crusey

NO.	PAY ITEM NO.	PAY ITEM DESCRIPTION	UNIT	QUANTITY	UNIT BID PRICE	BID AMOUNT
1	202(6)	Removal of Manhole	EA	3	\$2,000.00	\$6,000.00
2	202(8)	Removal of Inlet	EA	2	\$1,300.00	\$2,600.00
3	202(2)	Removal of Pavment	SY	7,950	\$5.00	\$39,750.00
4	202 (4)	Removal of Culvert Pipe	LF	285	\$20.00	\$5,700.00
5	202(9)	Removal of Curb and Gutter	LF	3,000	\$20.00	\$60,000.00
6	204(1)	Structure Excavtion	CY	2,200	\$10.00	\$22,000.00
7	203(6A)	Borrow, Type A	TON	43,700	\$12.00	\$524,400.00
8	301(1)	Aggregate Base Course, Grading D-1	TON	900	\$25.00	\$22,500.00
9	401(1A)	Hot Mix Asphalt, Type II: Class A	TON	920	\$130.00	\$119,600.00
10	401(2B)	Asphalt Cement, Grade PG 64-34	TON	51	\$650.00	\$33,150.00
11	402(1)	STE-1 Asphalt for Tack Coat	TON	10	\$1,200.00	\$12,000.00
12	603(1-12)	12 Inch Corrugated Polyethylene Pipe	LF	120	\$40.00	\$4,800.00
13	603(1-24)	24 Inch Corrugated Polyethylene Pipe	LF	1,366	\$65.00	\$88,790.00
16	604(1)	Storm Sewer Manhole, Type 1	EACH	5	\$6,000.00	\$30,000.00
17	604(5)	Inlet, Type A	EACH	8	\$3,500.00	\$28,000.00
14	608(1A)	Concrete Sidewalk, 4 inches Thick	SY	1,120	\$55.00	\$61,600.00
15	609(2)	Curb and Gutter, Type A	LF	3,000	\$35.00	\$105,000.00
18	635(2)	Insulation Board	SF	3,960	\$3.00	\$11,880.00
26	639 (2)	Commercial Driveway	EACH	9	\$1,000.00	\$9,000.00
19	640(1)	Mobilization and Demobilization	L.S.	All Req'd	\$50,000.00	\$50,000.00
20	641(1)	Erosion Pollution Control Administration	L.S.	All Req'd	\$5,000.00	\$5,000.00
21	641(2)	Temporary Erosion, Sediment and Pollution Control	C.S.	All Req'd	\$5,000.00	\$5,000.00
25	643 (25)	Traffic Control	CS	All Req'd	\$225,000.00	\$100,000.00



ENGINEER'S ESTIMATE

CITY OF WASILLA

**Swanson Avenue Basic Bid - Option A
 Raised Roadway With Gravity Flow S.D. System From Yenlo to Crusey**

NO.	PAY ITEM NO.	PAY ITEM DESCRIPTION	UNIT	QUANTITY	UNIT BID PRICE	BID AMOUNT
22	670(1)	Painted Traffic Markings	LF	9,000	\$3.00	\$27,000.00
23	670(4)	Transverse Pavement Marking Lines	SF	800	\$5.00	\$4,000.00
24	670(5)	Transverse Markings, Words or Symbols	EACH	8	\$400.00	\$3,200.00

Swanson Avenue Basic Bid - Option A \$1,380,970.00

Contingency @ 25.00% = \$345,242.50

Option A Subtotal \$1,726,212.50

Option A Total \$1,726,212.50



ENGINEER'S ESTIMATE

CITY OF WASILLA

Swanson Avenue Basic Bid - Option B

Maintain Roadway Grade With Gravity Flow S.D. System From Yenlo to Crusey With Lift System

NO.	PAY ITEM NO.	PAY ITEM DESCRIPTION	UNIT	QUANTITY	UNIT BID PRICE	BID AMOUNT
1	202(6)	Removal of Manhole	EA	3	\$2,000.00	\$6,000.00
2	202(8)	Removal of Inlet	EA	2	\$1,300.00	\$2,600.00
3	202(2)	Removal of Pavment	SY	7,950	\$5.00	\$39,750.00
4	202 (4)	Removal of Culvert Pipe	LF	285	\$20.00	\$5,700.00
5	202(9)	Removal of Curb and Gutter	LF	600	\$20.00	\$12,000.00
6	204(1)	Structure Excavtion	CY	2,200	\$10.00	\$22,000.00
7	203(6A)	Borrow, Type A	TON	2,100	\$12.00	\$25,200.00
8	301(1)	Aggregate Base Course, Grading D-1	TON	900	\$25.00	\$22,500.00
9	401(1A)	Hot Mix Asphalt, Type II: Class A	TON	920	\$130.00	\$119,600.00
10	401(2B)	Asphalt Cement, Grade PG 64-34	TON	51	\$650.00	\$33,150.00
11	402(1)	STE-1 Asphalt for Tack Coat	TON	10	\$1,200.00	\$12,000.00
12	603(1-12)	12 Inch Corrugated Polyethylene Pipe	LF	120	\$40.00	\$4,800.00
13	603(1-24)	24 Inch Corrugated Polyethylene Pipe	LF	1,366	\$65.00	\$88,790.00
14	604(1)	Storm Sewer Manhole, Type 1	EACH	4	\$6,000.00	\$24,000.00
15	604(5)	Inlet, Type A	EACH	8	\$3,500.00	\$28,000.00
16	604(10)	Storm Drain Lift Station, Manhole, Pumps, Controls	LS	All Req'd	\$100,000.00	\$100,000.00
17	609(2)	Curb and Gutter, Type A	LF	1,690	\$35.00	\$59,150.00
18	635(2)	Insulation Board	SF	3,960	\$3.00	\$11,880.00
19	639 (2)	Commercial Driveway	EACH	9	\$1,000.00	\$9,000.00
20	640(1)	Mobilization and Demobilization	L.S.	All Req'd	\$50,000.00	\$50,000.00
21	641(1)	Erosion Pollution Control Administration	L.S.	All Req'd	\$5,000.00	\$5,000.00
22	641(2)	Temporary Erosion, Sediment and Pollution Control	C.S.	All Req'd	\$5,000.00	\$5,000.00
23	643 (25)	Traffic Control	CS	All Req'd	\$100,000.00	\$100,000.00
24	670(1)	Painted Traffic Markings	LF	9,000	\$3.00	\$27,000.00



ENGINEER'S ESTIMATE

CITY OF WASILLA

Swanson Avenue Basic Bid - Option B

Maintain Roadway Grade With Gravity Flow S.D. System From Yenlo to Crusey With Lift System

NO.	PAY ITEM NO.	PAY ITEM DESCRIPTION	UNIT	QUANTITY	UNIT BID PRICE	BID AMOUNT
25	670(4)	Transverse Pavement Marking Lines	SF	800	\$5.00	\$4,000.00
26	670(5)	Transverse Markings, Words or Symbols	EACH	8	\$400.00	\$3,200.00
Swanson Avenue Basic Bid - Option B						\$820,320.00
Contingency @ 15.00% =						\$123,048.00
Option B Subtotal						\$943,368.00
Option B Total						\$943,368.00



ENGINEER'S ESTIMATE

CITY OF WASILLA

Swanson Avenue Basic Bid - Option C
 Raised Roadway With Gravity Flow S.D. System From Yenlo to Crusey

NO.	PAY ITEM NO.	PAY ITEM DESCRIPTION	UNIT	QUANTITY	UNIT BID PRICE	BID AMOUNT
1	202(6)	Removal of Manhole	EA	3	\$2,000.00	\$6,000.00
2	202(8)	Removal of Inlet	EA	2	\$1,300.00	\$2,600.00
3	202(2)	Removal of Pavment	SY	7,950	\$5.00	\$39,750.00
4	202 (4)	Removal of Culvert Pipe	LF	285	\$20.00	\$5,700.00
5	202(9)	Removal of Curb and Gutter	LF	1,290	\$20.00	\$25,800.00
6	204(1)	Structure Excavtion	CY	2,200	\$10.00	\$22,000.00
7	203(6A)	Borrow, Type A	TON	2,100	\$12.00	\$25,200.00
8	301(1)	Aggregate Base Course, Grading D-1	TON	900	\$25.00	\$22,500.00
9	401(1A)	Hot Mix Asphalt, Type II: Class A	TON	920	\$130.00	\$119,600.00
10	401(2B)	Asphalt Cement, Grade PG 64-34	TON	51	\$650.00	\$33,150.00
11	402(1)	STE-1 Asphalt for Tack Coat	TON	10	\$1,200.00	\$12,000.00
12	603(1-12)	12 Inch Corrugated Polyethylene Pipe	LF	120	\$40.00	\$4,800.00
13	603(1-24)	24 Inch Corrugated Polyethylene Pipe	LF	1,366	\$65.00	\$88,790.00
16	604(1)	Storm Sewer Manhole, Type 1	EACH	5	\$6,000.00	\$30,000.00
17	604(5)	Inlet, Type A	EACH	8	\$3,500.00	\$28,000.00
14	608(1A)	Concrete Sidewalk, 4 inches Thick	SY	560	\$55.00	\$30,800.00
15	609(2)	Curb and Gutter, Type A	LF	1,290	\$35.00	\$45,150.00
18	635(2)	Insulation Board	SF	3,960	\$3.00	\$11,880.00
26	639 (2)	Commercial Driveway	EACH	9	\$1,000.00	\$9,000.00
19	640(1)	Mobilization and Demobilization	L.S.	All Req'd	\$50,000.00	\$50,000.00
20	641(1)	Erosion Pollution Control Administration	L.S.	All Req'd	\$5,000.00	\$5,000.00
21	641(2)	Temporary Erosion, Sediment and Pollution Control	C.S.	All Req'd	\$5,000.00	\$5,000.00
25	643 (25)	Traffic Control	CS	All Req'd	\$100,000.00	\$100,000.00
22	670(1)	Painted Traffic Markings	LF	9,000	\$3.00	\$27,000.00



ENGINEER'S ESTIMATE

CITY OF WASILLA

Swanson Avenue Basic Bid - Option C
Raised Roadway With Gravity Flow S.D. System From Yenlo to Crusey

NO.	PAY ITEM NO.	PAY ITEM DESCRIPTION	UNIT	QUANTITY	UNIT BID PRICE	BID AMOUNT
23	670(4)	Transverse Pavement Marking Lines	SF	800	\$5.00	\$4,000.00
24	670(5)	Transverse Markings, Words or Symbols	EACH	8	\$400.00	\$3,200.00

Swanson Avenue Basic Bid - Option C \$756,920.00

Contingency @ 15.00% = \$113,538.00

Option C Subtotal \$870,458.00

Option C Total \$870,458.00



ENGINEER'S ESTIMATE

CITY OF WASILLA

Swanson Avenue Add Alt

Additional Gravity Flow S.D. System From Main to Yenlo

NO.	PAY ITEM NO.	PAY ITEM DESCRIPTION	UNIT	QUANTITY	UNIT BID PRICE	BID AMOUNT
1	202(6)	Removal of Manhole	EA	4	\$2,000.00	\$8,000.00
2	202(8)	Removal of Inlet	EA	5	\$1,300.00	\$6,500.00
4	202 (4)	Removal of Culvert Pipe	LF	387	\$20.00	\$7,740.00
5	202(9)	Removal of Curb and Gutter	LF	40	\$20.00	\$800.00
6	204(1)	Structure Excavtion	CY	781	\$10.00	\$7,807.41
7	203(6A)	Borrow, Type A	TON	112	\$12.00	\$1,338.39
12	603(1-12)	12 Inch Corrugated Polyethylene Pipe	LF	49	\$40.00	\$1,960.00
13	603(1-24)	24 Inch Corrugated Polyethylene Pipe	LF	527	\$65.00	\$34,255.00
15	609(2)	Curb and Gutter, Type A	LF	40	\$35.00	\$1,400.00
16	604(1)	Storm Sewer Manhole, Type 1	EACH	3	\$6,000.00	\$18,000.00
17	604(5)	Inlet, Type A	EACH	4	\$3,500.00	\$14,000.00
18	639 (2)	Commercial Driveway	EACH	3	\$3,500.00	\$10,500.00
Swanson Avenue Add Alt						\$112,300.80
Contingency @ 15.00% =						\$16,845.12
Add Alt Total						\$129,145.92

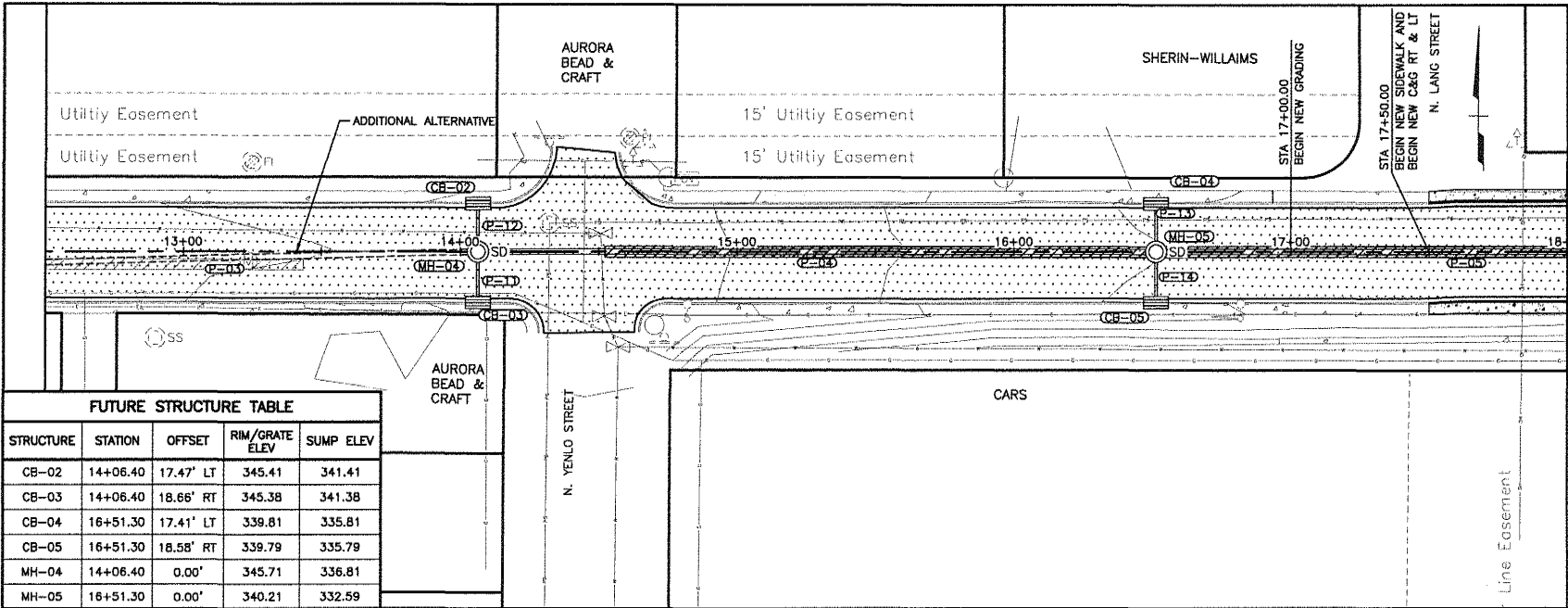

FUTURE STRUCTURE TABLE				
STRUCTURE	STATION	OFFSET	RIM/GRATE ELEV	SUMP ELEV
CB-02	14+06.40	17.47' LT	345.41	341.41
CB-03	14+06.40	18.66' RT	345.38	341.38
CB-04	16+51.30	17.41' LT	339.81	335.81
CB-05	16+51.30	18.58' RT	339.79	335.79
MH-04	14+06.40	0.00'	345.71	336.81
MH-05	16+51.30	0.00'	340.21	332.59

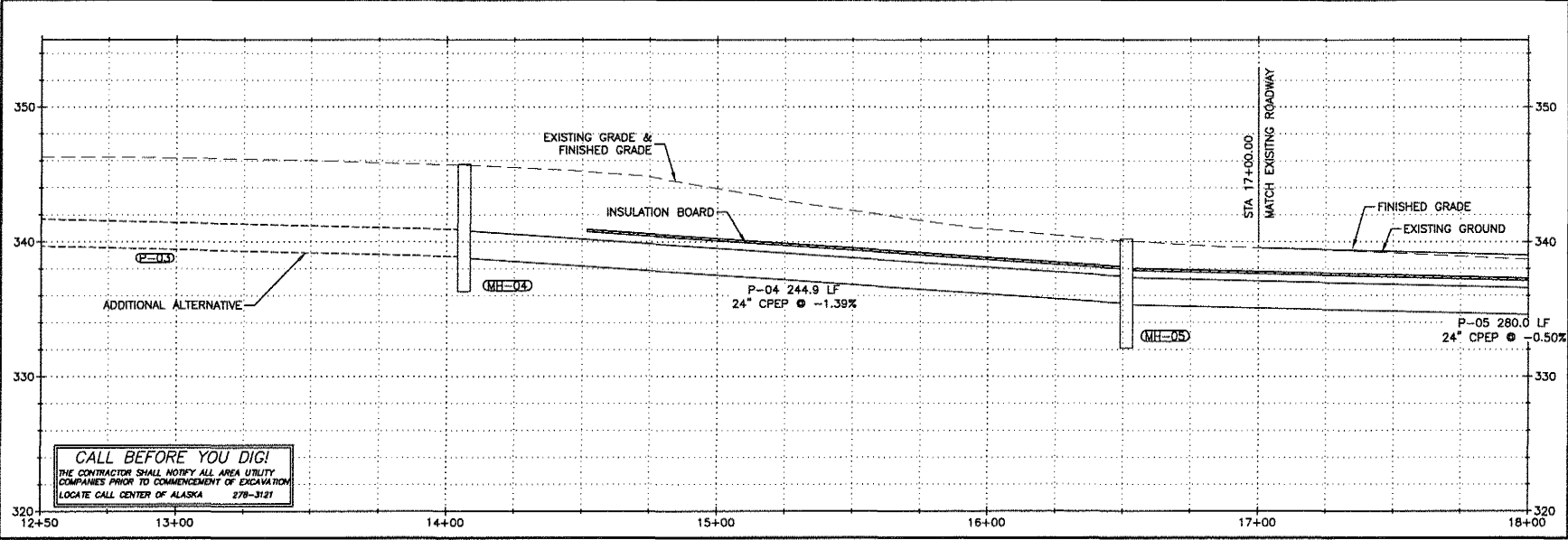

YEAR	SHEET NO.	TOTAL SHEETS
2011	F2	F4

PRELIMINARY DESIGN



R&M CONSULTANTS, INC.

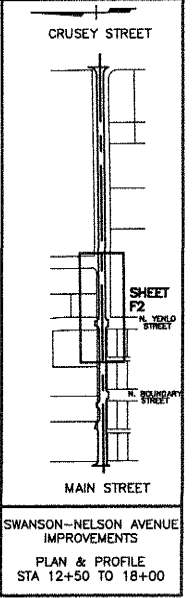

SHEET 7 OF XX

Printed 4/19/2011 4:05 PM by Kristen Keifer Z:\projects\1708.01 City of Wasilla Swanson Nelson Avenue\Civil\ACAD\1708.01-F01.dwg

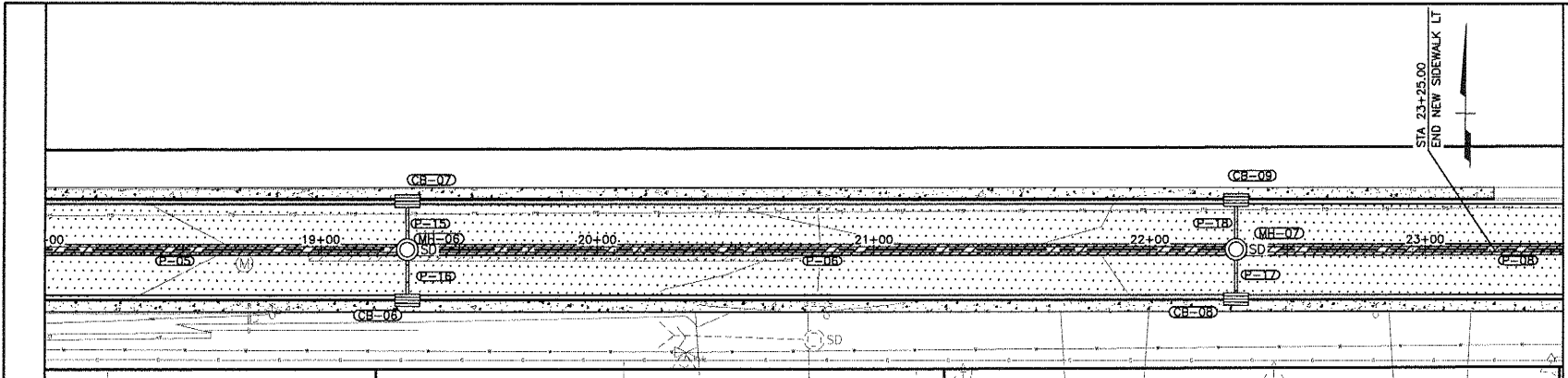

FUTURE STRUCTURE TABLE				
STRUCTURE	STATION	OFFSET	RIM/GRATE ELEV	SUMP ELEV
CB-06	19+31.35	18.35' RT	337.95	333.95
CB-07	19+31.26	17.60' LT	337.96	333.96
CB-08	22+31.30	18.02' RT	336.54	332.54
CB-09	22+31.30	17.93' LT	336.54	332.54
MH-06	19+31.30	0.00'	338.36	332.51
MH-07	22+31.30	0.00'	336.95	332.12

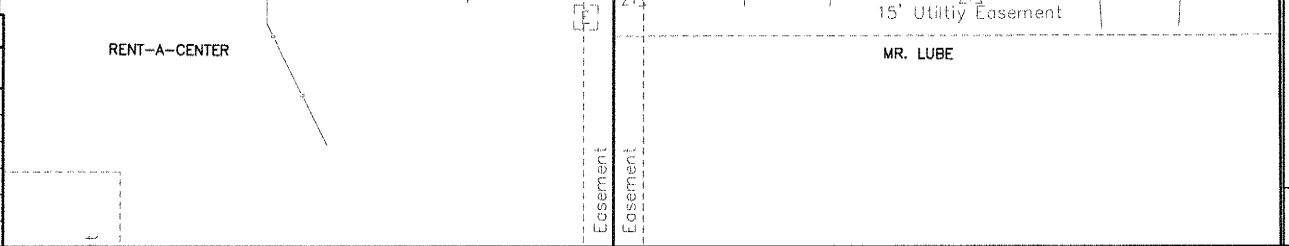

YEAR	SHEET NO.	TOTAL SHEETS
2011	F3	F4

PRELIMINARY DESIGN



R&M CONSULTANTS, INC.

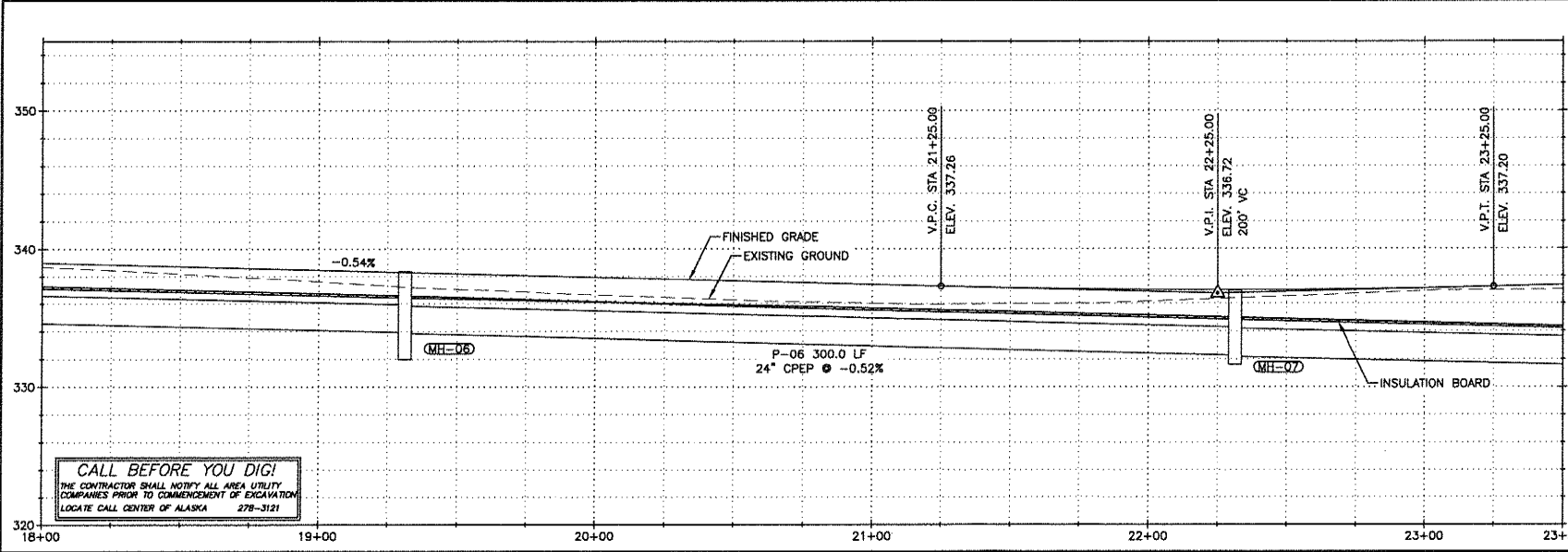

CALL BEFORE YOU DIG!
 THE CONTRACTOR SHALL NOTIFY ALL AREA UTILITY COMPANIES PRIOR TO COMMENCEMENT OF EXCAVATION. LOCATE CALL CENTER OF ALASKA 278-3121

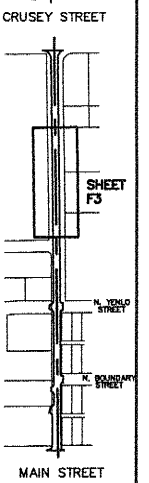

SWANSON-NELSON AVENUE IMPROVEMENTS
 PLAN & PROFILE
 STA 18+00 TO 23+50

SHEET 8 OF XX

Plotted 4/19/2011 4:05 PM by Kristen Keller Z:\project\1708.01 - City of Wasilla, Swanson Nelson Avenue\Civil\ACAD\1708.01-F01.dwg

FUTURE STRUCTURE TABLE				
STRUCTURE	STATION	OFFSET	RIM/GRATE ELEV	SUMP ELEV
MH-08	24+71.92	0.00'	337.98	328.90

STA 24+25.00
END NEW GRADING AND
END SIDEWALK & C&G RT

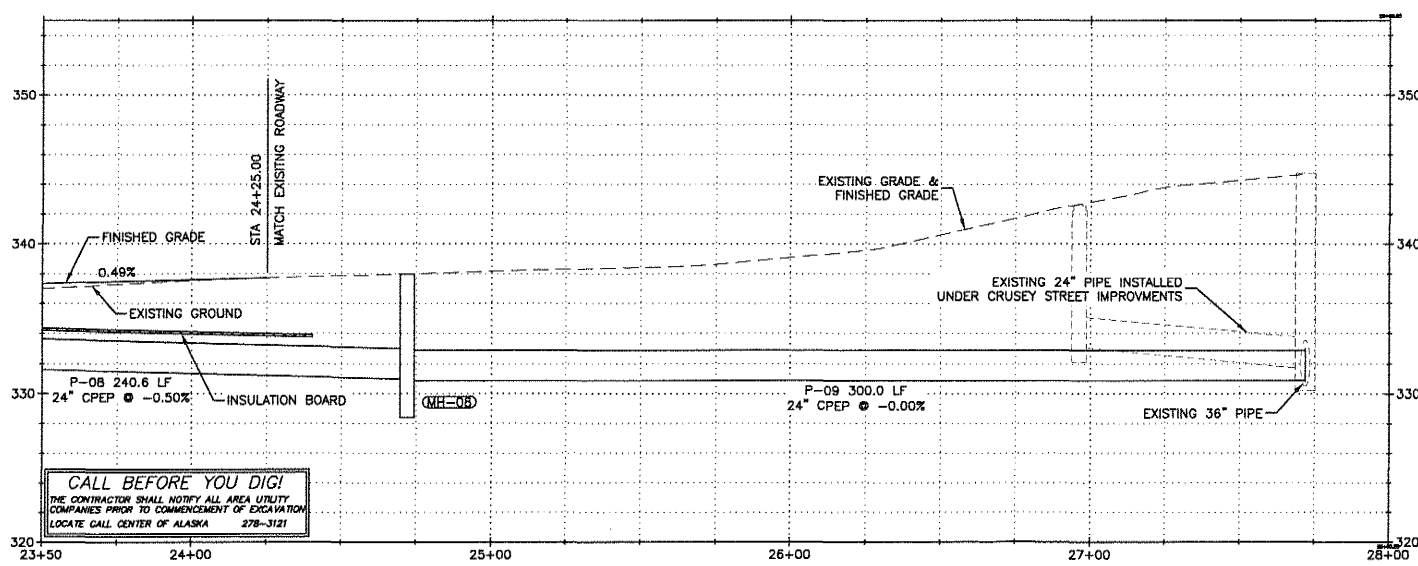
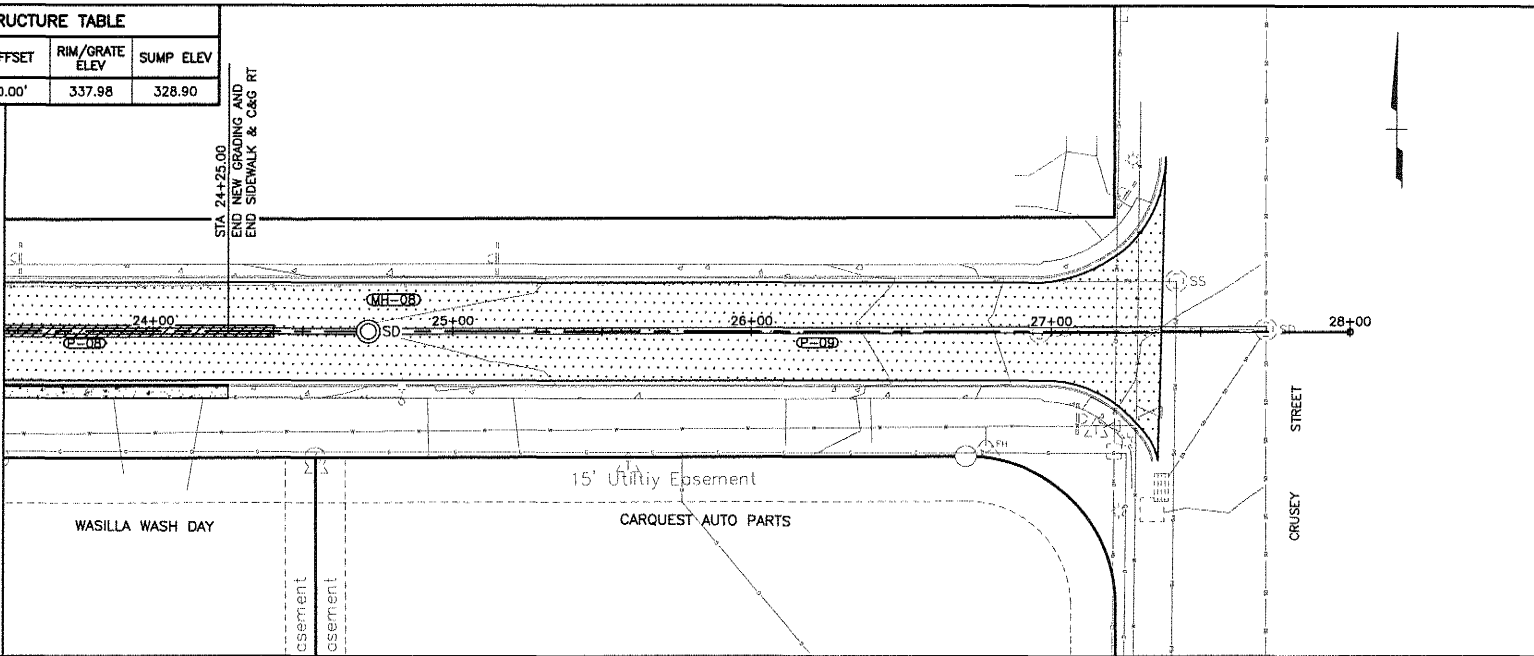

CALL BEFORE YOU DIG!
 THE CONTRACTOR SHALL NOTIFY ALL AREA UTILITY COMPANIES PRIOR TO COMMENCEMENT OF EXCAVATION.
 LOCATE CALL CENTER OF ALASKA 278-3121

YEAR	SHEET NO.	TOTAL SHEETS
2011	F4	F4

PRELIMINARY DESIGN



RBM CONSULTANTS, INC.

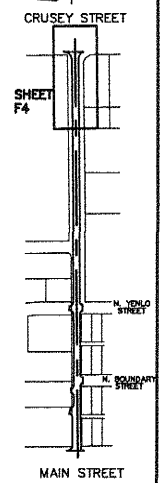

SWANSON-NELSON AVENUE IMPROVEMENTS
 PLAN & PROFILE
 STA 23+50 TO 28+00

SHEET 5 OF XX

Z:\project\1709.01 - City of Wasilla Swanson Nelson Avenue\Civil\ACAD\1709.01-F0.dwg
 Plotted 4/19/2011 4:04 PM by Kristen Keiser

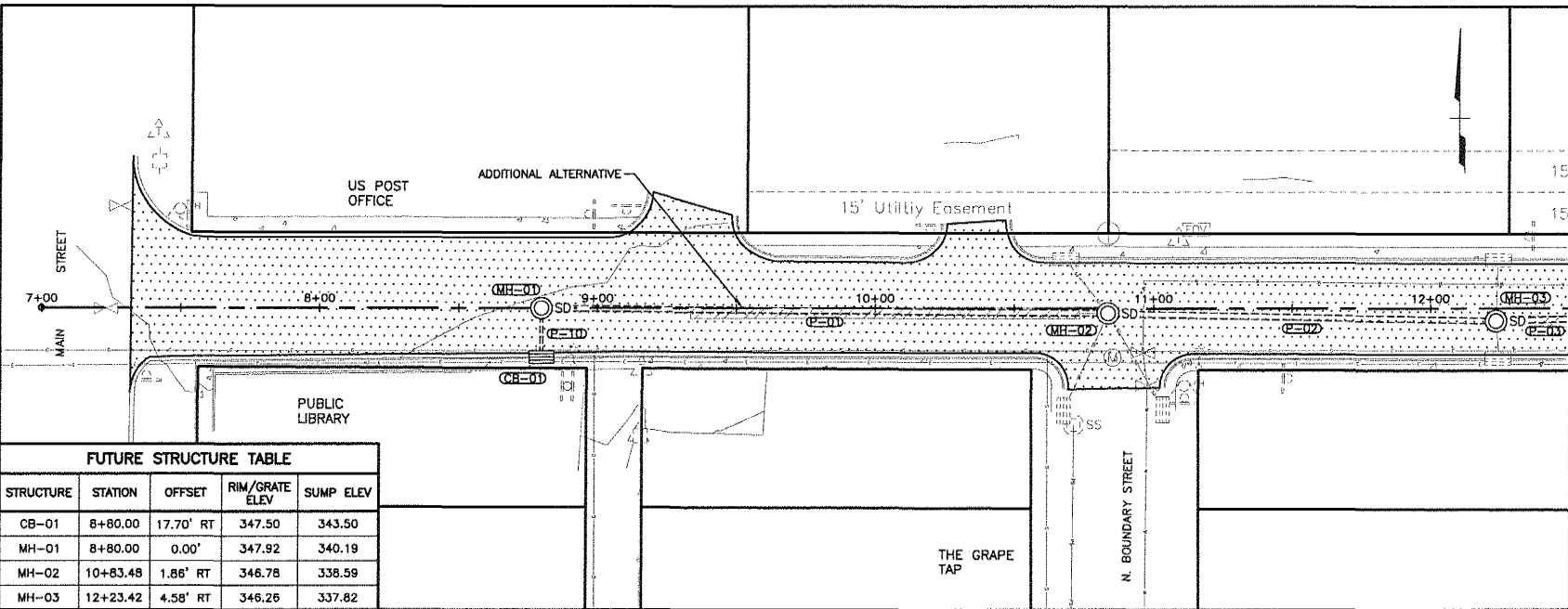

FUTURE STRUCTURE TABLE

STRUCTURE	STATION	OFFSET	RIM/GRATE ELEV	SUMP ELEV
CB-01	8+80.00	17.70' RT	347.50	343.50
MH-01	8+80.00	0.00'	347.92	340.19
MH-02	10+83.48	1.86' RT	346.78	338.59
MH-03	12+23.42	4.58' RT	346.26	337.82

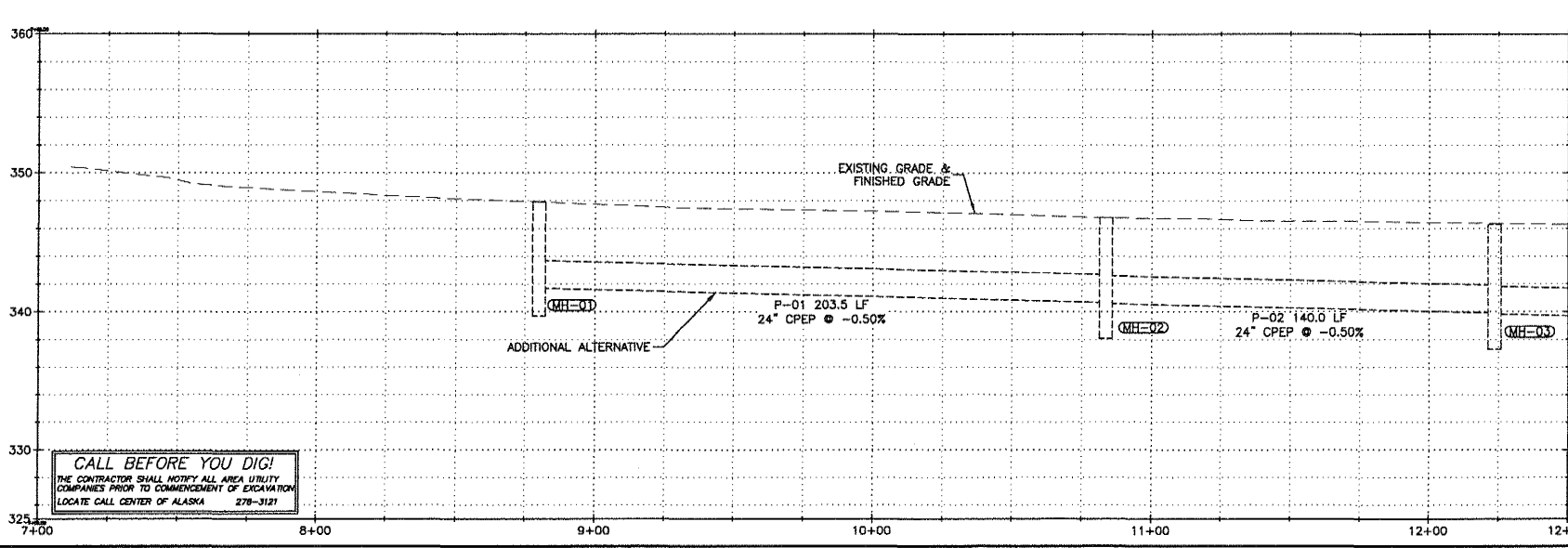

CALL BEFORE YOU DIG!
 THE CONTRACTOR SHALL NOTIFY ALL AREA UTILITY COMPANIES PRIOR TO COMMENCEMENT OF EXCAVATION
 LOCATE CALL CENTER OF ALASKA 278-3121

YEAR	SHEET NO.	TOTAL SHEETS
2011	F1	F4

PRELIMINARY DESIGN



RBM CONSULTANTS, INC.

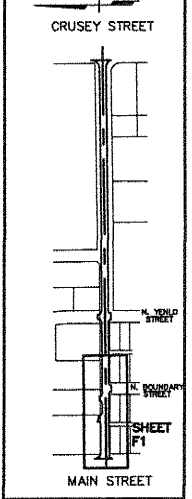

SWANSON-NELSON AVENUE IMPROVEMENTS
 PLAN & PROFILE
 STA 7+00 TO 12+50