



## CITY OF WASILLA

290 E. HERNING AVE.  
WASILLA, ALASKA 99654-7091  
PHONE: (907) 373-9050  
FAX: (907) 373-0788

### COUNCIL MEMORANDUM NO. 92-96

**From:** Deputy Administrator  
**Date:** August 20, 1992  
**Subject:** Request for Exemption to Sewer Connection

Mr. Rutledge is requesting a variance, or an exemption, from the City code that requires his structure to be connected to the City sewer system. There are no provisions in the code to allow such exemptions or variances.

There have been no exceptional or compelling circumstances asserted that should be considered as warranting a variance even if such a procedure were available.

Administration believes it would be an improper action for Council to not enforce the laws of the City by granting the request. We strongly recommend that Mr. Rutledge be required to connect his sewer system to the City system in accordance with City code.

  
\_\_\_\_\_  
Robert E. Harris  
Deputy Administrator

REH/sbh

*No Action Taken  
C/M 8-24-92*

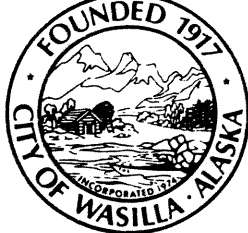

## CITY OF WASILLA

290 E. HERNING AVE.  
WASILLA, ALASKA 99654-7091  
PHONE: (907) 373-9050  
FAX: (907) 373-0788

August 13, 1992

Richard Rutledge  
P. O. Box 878405  
Wasilla, AK 99687

RE: Sewer Connection

Dear Mr. Rutledge:

This is in response to your request to install an on-site sewer disposal system. On August 10, 1992 the City Council considered and rejected a motion to rescind the City's mandatory sewer connection requirement. Therefore, your property will be required to install a system in accordance with City Code and connect to the City system.

Since your property has not been assessed for the sewer construction there will be a \$750.00 fee which can be paid in monthly installments along with the regular service fees of \$22.00 per month. We will be available to work with you on the installation of your system to help keep construction costs as low as possible. Please contact Doug Abbas, City of Wasilla Public Works Department, 373-9095 prior to beginning construction for advice and assistance .

Sincerely,

Robert E. Harris  
Director of Public Works

cc: Doug Abbas  
Sharon (Utility Billing)

the standpoint of source, it may be a combination of the liquid and water carried wastes from residences, commercial buildings, industrial plants, and institutions.

AH. "Wastewater Facilities" means the structures, equipment, and processes required to collect, carry away, and treat domestic and industrial wastes and dispose of the effluent. Wastewater facilities include the interceptor tanks, pumping facilities, service lines, system piping and control panels. May be used interchangeably with "Sewer Facilities".

AI. "Wastewater Treatment Works" means an arrangement of devices and structures for treating wastewater, industrial wastes, and sludge. Sometimes used as synonymous with "waste treatment plant" or "wastewater treatment plant" or "water pollution control plant", or "Sewage treatment plant".

AJ. "Water Course" means a natural or artificial channel for the passage of water either continuously or intermittently.

AK. "Duplex" means a residential building(s) containing two (2) separate living units. Each living unit shall be as an individual residential sewer customer.

AL. "Triplex" means a residential building(s) containing three (3) separate living units. Each living unit shall be as an individual residential sewer customer. (Ord. 89-01 §3 1989)

#### 5.20.020 Use of Public Sewer Required.

A. The wastewater plumbing of any structure constructed after March 1, 1989 must be connected to the City public sewer system in accordance with the provisions of this chapter unless the structure is more than one hundred fifty (150) feet from any portion of the sewer system as measured in a straight line from the sewer system piping to the nearest exterior lot line on which the structure is located.

B. Where the City public sewer system is not available under the provisions of paragraph A, above, the building sewer shall be connected to a private wastewater disposal system complying with the subsurface sewage disposal provisions of the State of Alaska, Department of Environmental Conservation. (Ord. 89-01 §3 1989)

#### 5.20.030 General Conditions of Construction of Sewer Connections.

A. All materials used in the construction of a Sewer Connection from and including the interceptor tank to the sewer lateral or main line shall be the property of the City whether purchased and/or installed by the applicant or by the City.

City of Wasilla:

RE. SEWER CONNECTION

I HAVE LOT 1 BLK 3 CREEKSIDE SUB  
CORNER OF GLENWOOD & THOMAS IN WASILLA  
WE WOULD LIKE TO INSTALL OUR OWN SEPTIC  
SYSTEM PER D.E.C. APPROVAL. AS WE  
WOULD HAVE A LONG LINE TO THE CITY  
LINE ON THE OTHER SIDE OF GLENWOOD

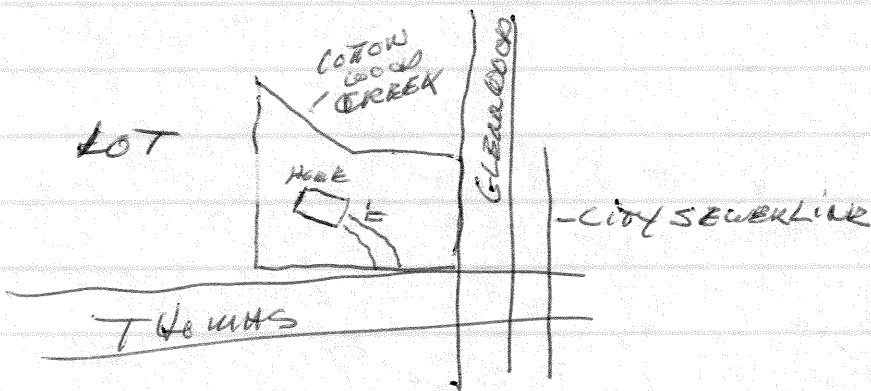

WE APPRECIATE ANY CONSIDERATION YOU  
CAN HELP US WITH. TO HELP CUT THE  
COST OF OUR SYSTEM AND TO THE COST  
OF OPERATING AFTER INSTALLATION.

Sincerely

*Richard Rutledge*

RICHARD E. RUTLEDGE

PO BOX 878405

WASILLA AK 99687

PH 376 9237 MESSAGE

**RECEIVED**  
MUNICIPAL SERVICES

AUG 10 1992

City Council

City of Wasilla

8-19-92

I would like to ask the City of Wasilla to consider giving a special variance to let us install an on site sewer private sewer system. On Lot 1 Block 3 Creekside Sub. Per D.E.C. approval.

The lot contains 1.67 acres. It is 300 feet from the house stub stub out to the main sewer line. Which could cause a problem in in the length of the run.

Chapter 5.20.020 Use of public Sewer Required.

Mentions that a structure over 150 feet. Is this because there might be a problem in long runs?

Thank you for your consideration of this problem.

Sincerely

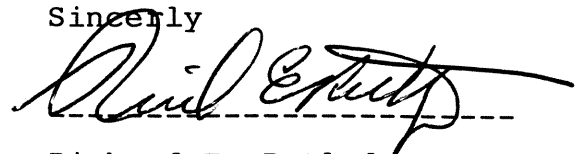
A handwritten signature in cursive script, appearing to read "Richard E. Rutledge", written over a horizontal dashed line.

Richard E. Rutledge

376-9237

PRELIMINARY SEWER INSPECTION REPORT

PERMIT TYPE SEWER  
 SUBDIVISION CREEKSIDE BLOCK 3 LOT 1

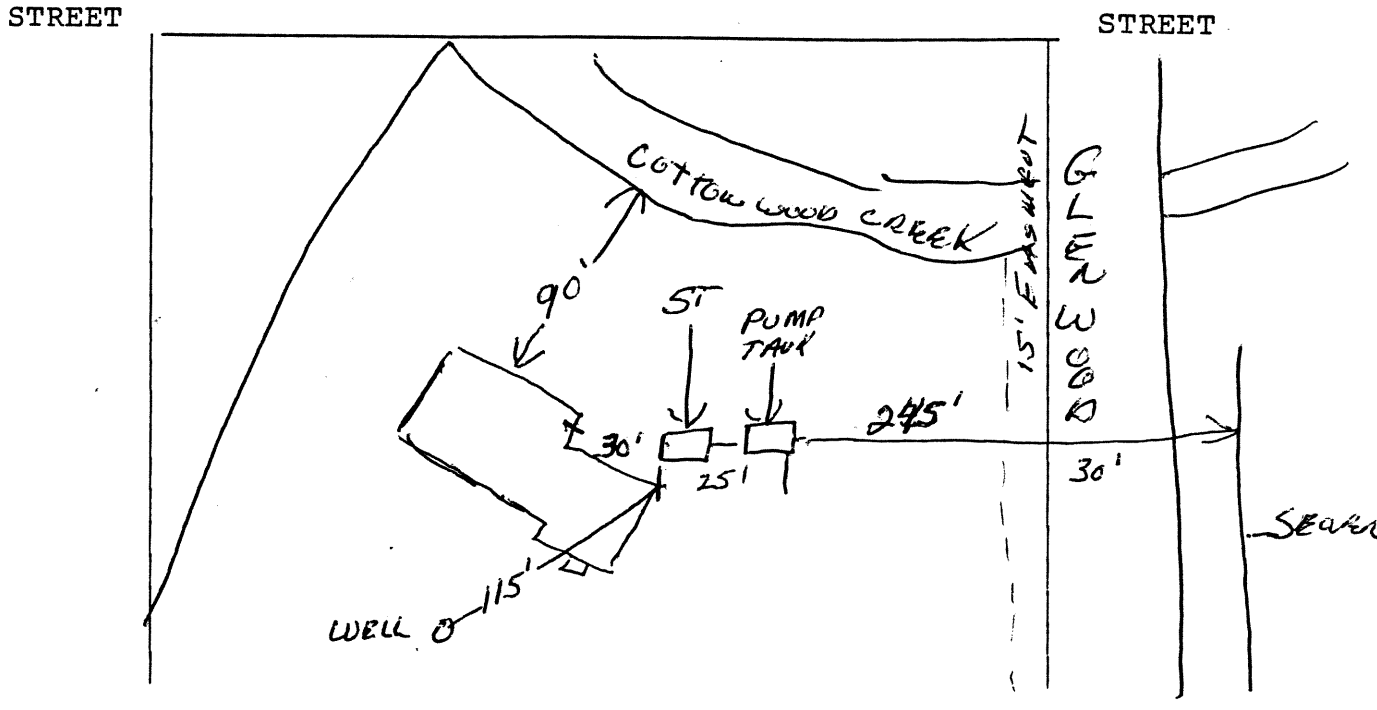

SEWER SERVICE LINE SKETCH THOMAS

Show location of septic tank(s), pump basin(s), pump conduit, control box, service line, main line, and all wells within 200 feet. Swing tie all distances to permanent markers.

Well Classification: A \_\_\_\_\_ B \_\_\_\_\_ C \_\_\_\_\_ Private X

Size Main \_\_\_\_\_ Connect depth at main \_\_\_\_\_

Type Main \_\_\_\_\_ Connect depth at stub out \_\_\_\_\_

Connect Location \_\_\_\_\_

Septic tank size (gal.) 1500 Type Tank STEEL

Pump Manufacturer \_\_\_\_\_ H.P. \_\_\_\_\_ Head \_\_\_\_\_

Minimum depth of bury at top of tank \_\_\_\_\_

Minimum opening of manway riser \_\_\_\_\_ inches.  
 (Steps are required in manway risers greater than 4 feet.)

Clean out caps installed  Yes  No

Comments \_\_\_\_\_

Inspected by: \_\_\_\_\_ Date \_\_\_\_\_